

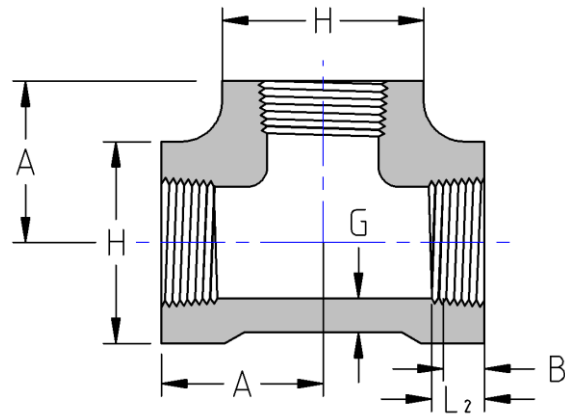

Threaded Tee
6000# Forged Steel
Inches / Pounds



Size	A	H	G (Minimum)	B**	L ₂ ** (Minimum)	Approximate Weight (in Pounds)
1/2	1.50	1.81	0.321	0.43	0.5337	2.13
3/4	1.75	2.19	0.336	0.50	0.5457	3.63
1	2.00	2.44	0.391	0.58	0.6828	4.63
1 1/4	2.38	2.97	0.417	0.67	0.7068	7.63
1 1/2	2.50	3.31	0.436	0.70	0.7235	9.63
2	3.25	4.00	0.476	0.75	0.7565	18.90

***ASME B16.11**

****Dimension B is minimum length of perfect thread. The length of useful thread (B plus threads with fully formed roots and flat crests) shall not be less than L₂ (effective length of external thread) required by ASME B1.20.1**