

NON FHA PLATE
FIG. 241G

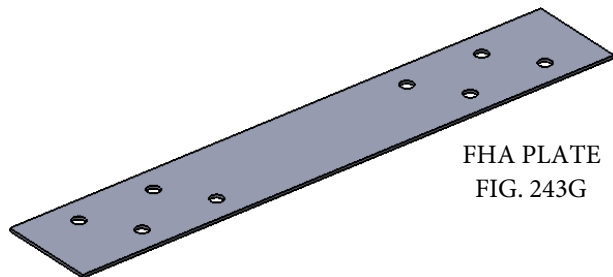

FHA PLATE
FIG. 243G

Materials/Finishes:	(NON-FHA) Electro-Galvanized Carbon Steel (241G)
Variants:	(FHA) Electro-Galvanized Carbon Steel (243G)
Service:	Designed to protect piping and electrical lines that pass through wood framing from damage due to penetration from drywall or other fasteners. Attach with metal framing screws.
Approvals:	N/A
Ordering:	Specify figure number, gauge and size.
Notes:	N/A

PROTECTIVE PLATES (NON-FHA)-241G SERIES		
GAUGE	SIZE WIDTH X LENGTH	WGT EACH (lbs)
18	1-1/2 x 3	0.065
18	1-1/2 x 6	0.125

PROTECTIVE PLATES (FHA)-243G SERIES		
GAUGE	SIZE WIDTH X LENGTH	WGT EACH (lbs)
18	1-1/2 X 9	0.180
18	1-1/2 X 12	0.250
18	1-1/2 X 18	0.380
18	1-1/2 X 24	0.500
18	3 X 6	0.250
18	3 X 9	0.380
18	3 X 12	0.520
18	3 X 18	0.780
16	1-1/2 X 9	0.240
16	1-1/2 X 12	0.320
16	1-1/2 X 18	0.480
16	1-1/2 X 24	0.640
13	1-1/2 X 9	0.350
13	1-1/2 X 12	0.470
13	1-1/2 X 18	0.700
13	1-1/2 X 24	0.980



PROJECT INFORMATION	APPROVAL STAMP
Project:	Notes:
Address:	
Contractor:	
Engineer:	
Date:	
Approved Approved as Noted Not Approved	