

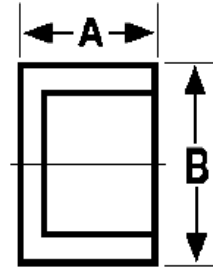

Socket Weld Cap
6000# Forged Steel
Inches / Pounds



Size	A	B	Approximate Weight (in Pounds)
1/2	0.81	1.33	0.42
3/4	0.81	1.62	0.58
1	0.94	1.96	1.18
1 1/4	0.94	2.31	1.41
1 1/2	1.00	2.62	2.17
2	1.19	3.27	3.67

****ASTM SA-105, ANSI B16.11***