

140EF UL Epoxy Coated Y Strainer

Specification Sheet

FEATURES & BENEFITS

- Meet or exceed the requirements of UL 321 Standard
- NPT – Blow-off outlets are furnished with plugs
- Recessed body seat assures accurate screen alignment
- Flanged Ends to ANSI B16.1, Class 125, ASME B16.42, Class 150
- Fusion Bonded Interior and Exterior – AWWA C550 Standard.
- Rated Working Pressure – 175 psi. 2:1 Safety Factor.
- Underwriters Laboratories (UL / ULC) Listed.
- Sizes 2-1/2" - 12"



MATERIAL SPECIFICATIONS

Part	Material	ASTM Specifications
Body	Gray Cast Iron	A126 Class B
Cover	Gray Cast Iron	A126 Class B
Screen	Stainless Steel	A276 Type 304
Body/Cover Gasket	PTFE/Graphite	Commercial
Body/Cover Bolts	Carbon Steel	A307 Grade B
Plug	Malleable Iron	A47 Grade 22010

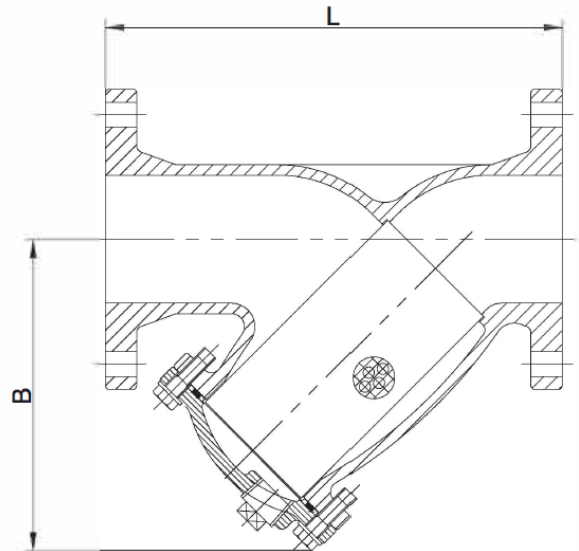

Standard Screen (inch)

Size	Hole Diameter	Free Flow Area Opening
2-1/2"	0.12	53.60%
3" to 5"	0.17	55.43%
6" to 10"	0.24	63.00%
12"	0.25	40.70%

DIMENSIONS

Part #	140EF09	140EF10	140EF11	140EF13	140EF14	140EF15	140EF16
Size	2-1/2"	3"	4"	6"	8"	10"	12"
L	10.75	11.63	13.88	18.50	21.38	26.00	30.31
B	5.50	8.00	9.50	12.00	16.00	19.00	22.00
Plug Size	1"	1"	1"	1-1/2"	1-1/2"	2"	2"

