



MALLEABLE IRON PIPE FITTINGS



FIG NO. 3
(Elbows 90)
Page. 5



FIG NO. 4
(Red Elbows 90)
Page. 6



FIG NO. 6
(Elbows 45)
Page. 7



FIG NO. 7B
(Street Elbows 90)
Page. 8



FIG NO. -
(Street Elbows 45)
Page. 9



FIG NO. 13
(Tees)
Page. 9 - 10



FIG NO. 14
(Red Tees)
Page. 11-13



FIG NO. 19A
(Crosses)
Page. 14



FIG NO. 21A
(Caps)
Page. 14 -15



FIG NO. 24B
(Couplings)
Page. 16



FIG NO. 26
(Red Couplings)
Page. 17



FIG NO. 29
(Locknuts)
Page. 18



FIG NO. 32
(Nipples)
Page. 18



FIG NO. 30
(Bushings)
Page. 19 - 20



FIG NO. 31A
(Square Head Plugs)
Page. 21



FIG NO. 31B
(Slotted Head Plugs)
Page. 21



FIG NO. 35B
(Union Brass)
Page. 22

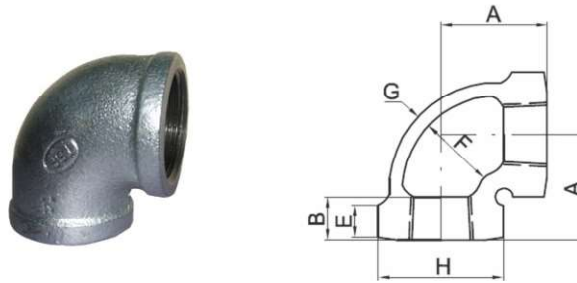

FIG NO. 35C
(Union Non Brass)
Page. 23



FLOOR FLANGE

Fig No. 3 - ELBOWS 90° BANDED (BL 90)



Dimension of Class 150 - (in Inch)							
SIZE	A	B (min)	E (min)	F		G	H (min)
				Min	Max		
1/4"	0.81	0.32	0,21	0,54	0,58	0,09	0,84
3/8"	0.95	0.36	0,23	0,67	0,72	0,10	1,01
1/2"	1.12	0.43	0,25	0,84	0,90	0,10	1,20
3/4"	1.31	0.50	0,27	1,05	1,11	0,12	1,46
1"	1.50	0.58	0,30	1,31	1,38	0,13	1,77
1¼"	1.75	0.67	0,34	1,66	1,73	0,14	2,15
1½"	1.94	0.70	0,37	1,90	1,97	0,15	2,43
2"	2.25	0,75	0,42	2,37	2,44	0,17	2,96
2½"	2.70	0,92	0,48	2,87	2,97	0,21	3,59
3"	3.08	0,98	0,55	3,50	3,60	0,23	4,28
3½"	3.42	1,03	0,60	4,00	4,10	0,25	4,84
4"	3.79	1,08	0,66	4,50	4,60	0,26	5,40
5"	4.50	1,18	0,78	5,56	5,56	0,30	6,58
6"	5.13	1,28	0,90	6,62	6,72	0,34	7,77

Dimension of Class 300 - (in Inch)							
SIZE	A	B (min)	E (min)	F		G	H (min)
				Min	Max		
1/2"	1,25	0,57	0,50	0,84	0,90	0,16	1,34
3/4"	1,44	0,64	0,56	1,05	1,11	0,18	1,63
1"	1,63	0,75	0,62	1,31	1,38	0,20	1,95
1¼"	1,94	0,84	0,69	1,66	1,73	0,22	2,39
1 ½"	2,13	0,87	0,75	1,90	1,97	0,24	2,68
2"	2,50	1,00	0,84	2,37	2,44	0,26	3,28

Fig No. 4 - REDUCING ELBOWS 90° BANDED (BRL)

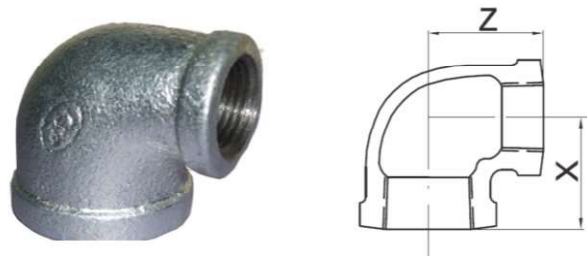

Dimension of Class 150 - (in Inch)		
SIZE	X	Z
1/4 X 1/8"	0,74	0,76
3/8 X 1/4"	0,88	0,90
3/8 X 1/8"	0,81	0,85
1/2 X 3/8"	1,04	1,03
1/2 X 1/4"	0,97	0,98
3/4 X 1/2"	1,20	1,22
3/4 X 3/8"	1,12	1,13
3/4 X 1/4"	1,05	1,08
1 X 3/4"	1,37	1,45
1 X 1/2"	1,26	1,36
1 X 3/8"	1,18	1,27
1¼ X 1"	1,58	1,67
1¼ X 3/4"	1,45	1,62
1¼ X 1/2"	1,34	1,53
1½ X 1¼"	1,82	1,88
1½ X 1"	1,65	1,80
1½ X 3/4"	1,52	1,75
2 X 1½"	2,02	2,16
2 X 1¼"	1,90	2,10
2 X 1"	1,73	2,02
2 X 3/4"	1,60	1,97
2½ X 2"	2,39	2,60
2½ X 1½"	2,16	2,51
3 X 2½"	2,83	2,99
3 X 2"	2,52	2,89
4 X 3"	3,30	3,60

Note : For dimensions not given, see the dimensions table of Elbow

Fig No. 6 - ELBOWS 45° BANDED (BL 45)

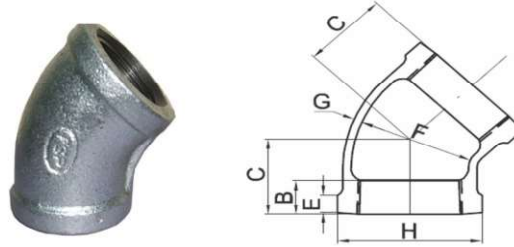

Dimension of Class 150 - (in Inch)							
SIZE	C	B (min)	E (min)	F		G	H (min)
				Min	Max		
1/4"	0,73	0,32	0,21	0,54	0,58	0,09	0,84
3/8"	0,80	0,36	0,23	0,67	0,72	0,10	1,01
1/2"	0,88	0,43	0,25	0,84	0,90	0,10	1,20
3/4"	0,98	0,50	0,27	1,05	1,11	0,12	1,46
1"	1,12	0,58	0,30	1,31	1,38	0,13	1,77
1¼"	1,29	0,67	0,34	1,66	1,73	0,14	2,15
1½"	1,43	0,70	0,37	1,90	1,97	0,15	2,43
2"	1,68	0,75	0,42	2,37	2,44	0,17	2,96
2½"	1,95	0,92	0,48	2,87	2,97	0,21	3,59
3"	2,17	0,98	0,55	3,50	3,60	0,23	4,28
3½"	2,39	1,03	0,60	4,00	4,10	0,25	4,84
4"	2,61	1,08	0,66	4,50	4,60	0,26	5,40
5"	3,05	1,18	0,78	5,56	5,66	0,30	6,58
6"	3,46	1,28	0,90	6,62	6,72	0,34	7,77

Dimension of Class 300 - (in Inch)							
SIZE	C	B (min)	E (min)	F		G	H (min)
				Min	Max		
1/2"	1,00	0,57	0,50	0,84	0,90	0,16	1,34
3/4"	1,13	0,64	0,56	1,05	1,11	0,18	1,63
1"	1,31	0,75	0,62	1,31	1,38	0,20	1,95
1¼"	1,50	0,84	0,69	1,66	1,73	0,22	2,39
1½"	1,69	0,87	0,75	1,90	1,97	0,24	2,68
2"	2,00	1,00	0,84	2,37	2,44	0,26	3,28

Fig No. 7B - STREET ELBOWS 90° BANDED (BSL 90)

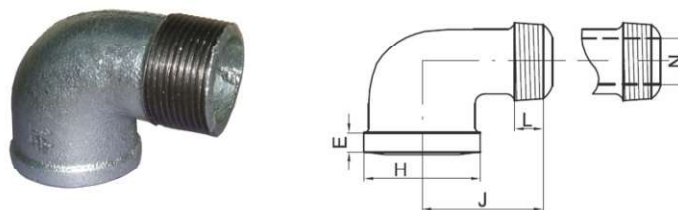

Dimension of Class 150 - (in Inch)						
SIZE	A	E (min)	H (min)	J	L (min)	N
1/8"	0,69	0,20	0,69	1,00	0,26	0,20
1/4"	0.81	0,21	0,84	1,19	0,40	0,26
3/8"	0.95	0,23	1,01	1,44	0,41	0,37
1/2"	1.12	0,25	1,20	1,63	0,53	0,51
3/4"	1.31	0,27	1,46	1,89	0,55	0,69
1"	1.50	0,30	1,77	2,14	0,68	0,91
1¼"	1.75	0,34	2,15	2,45	0,71	1,19
1½"	1.94	0,37	2,43	2,69	0,72	1,39
2"	2.25	0,42	2,96	3,26	0,76	1,79
2½"	2.70	0,48	3,59	3,86	1,14	2,20
1"	1.50	0,30	1,77	2,14	0,68	0,91
1¼"	1.75	0,34	2,15	2,45	0,71	1,19
1½"	1.94	0,37	2,43	2,69	0,72	1,39
2"	2.25	0,42	2,96	3,26	0,76	1,79

Dimension of Class 300 - (in Inch)					
SIZE	A	H (min)	J	L (min)	N
1/2"	1.25	1.34	2.00	0.53	0.49
3/4"	1.44	1.63	2.19	0.55	0.67
1"	1.63	1.95	2.56	0.68	0.88
1 ¼"	1.94	2.39	2.88	0.71	1.16
1½"	2.13	2.68	3.13	0.72	1.35
2"	2.50	3.28	3.69	0.76	1.75

STREET ELBOWS 45° BANDED (BSL 45)

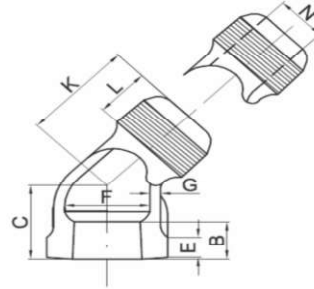

Dimension of Class 150 - (in Inch)									
SIZE	C	B (min)	E (min)	F		G	K	L (min)	N
				Min	Max				
1/4"	0.73	0.32	0.21	0.54	0.58	0.09	0.94	0.40	0.26
3/8"	0.80	0.36	0.23	0.67	0.72	0.10	1.03	0.41	0.37
1/2"	0.88	0.43	0.25	0.84	0.90	0.10	1.15	0.53	0.51
3/4"	0.98	0.50	0.27	1.05	1.11	0.12	1.29	0.55	0.69
1"	1.12	0.58	0.30	1.31	1.38	0.13	1.47	0.68	0.91
1¼"	1.29	0.67	0.34	1.66	1.73	0.14	1.71	0.71	1.19
1½"	1.43	0.70	0.37	1.90	1.97	0.15	1.88	0.72	1.39
2"	1.68	0.75	0.42	2.37	2.44	0.17	2.22	0.76	1.79
2½"	1.95	0.92	0.48	2.87	2.97	0.21	2.57	1.14	2.20
3"	2.17	0.98	0.55	3.50	3.60	0.23	3.00	1.20	2.78
4"	2.61	1.08	0.66	4.50	4.60	0.26	3.70	1.30	3.70
5"	-	1.18	0.78	5.56	5.66	0.30	-	1.41	4.69
6"	-	1.28	0.90	6.62	6.72	0.34	-	1.51	5.67

Fig No. 13 - TEES BANDED (BT)

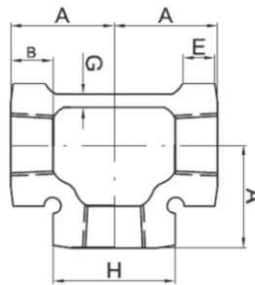

Dimension of Class 150 - (in Inch)					
SIZE	A	B (min)	E (min)	G	H (min)
1/8"	0.69	0.25	0.20	0.09	0.69
1/4"	0.81	0.32	0.21	0.09	0.84
3/8"	0.95	0.36	0.23	0.10	1.01
1/2"	1.12	0.43	0.25	0.10	1.20
3/4"	1.31	0.50	0.27	0.12	1.46
1"	1.50	0.58	0.30	0.13	1.77

Fig No. 13 - TEES BANDED (BT)

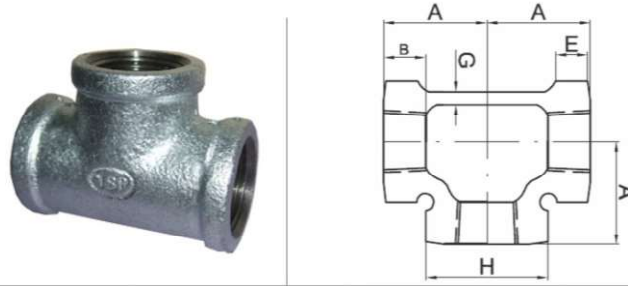

Dimension of Class 150 - (in Inch)

SIZE	A	B (min)	E (min)	G	H (min)
1¼"	1.75	0.67	0.34	0.14	2.15
1½"	1.94	0.70	0.37	0.15	2.43
2"	2.25	0.75	0.42	0.17	2.96
2½"	2.70	0.92	0.48	0.21	3.59
3"	3.08	0.98	0.55	0.23	4.28
3½"	3.42	1.03	0.60	0.25	4.84
4"	3.79	1.08	0.66	0.26	5.40
5"	4.50	1.18	0.78	0.30	6.58
6"	5.13	1.28	0.90	0.34	7.77

Dimension of Class 300 - (in Inch)

SIZE	A	B (min)	E (min)	G	H (min)
1/2"	1.25	0.57	0.50	0.16	1.34
3/4"	1.44	0.64	0.56	0.18	1.63
1"	1.63	0.75	0.62	0.20	1.95
1¼"	1.94	0.84	0.69	0.22	2.39
1½"	2.13	0.87	0.75	0.24	2.68
2"	2.50	1.00	0.84	0.26	3.28

Fig No. 14 - REDUCING TEES BANDED (BRT)



Dimension of Class 150 - (in Inch)							
SIZE	X	Y	Z	SIZE	X	Y	Z
1/4 X 1/4 X 1/8"	0.74	0.74	0.76	1 X 1 X 1/2"	1.26	1.26	1.36
1/8 X 1/8 X 1/4"	0.76	0.76	0.74	1 X 1 X 3/8"	1.18	1.18	1.27
3/8 X 3/8 X 1/4"	0.88	0.88	0.90	1 X 1 X 1/4"	1.11	1.11	1.22
3/8 X 3/8 X 1/8 "	0.81	0.81	0.85	1 X 3/4 X 1"	1.50	1.45	1.50
3/8 X 1/4 X 3/8"	0.95	0.90	0.95	1 X 3/4 X 3/4"	1.37	1.31	1.45
3/8 X 1/4 X 1/4"	0.88	0.81	0.90	1 X 3/4 X 1/2"	1.26	1.20	1.36
1/4 X 1/4 X 3/8"	0.90	0.90	0.88	1 X 1/2 X 1"	1.50	1.36	1.50
1/2 X 1/2 X 3/8"	1.04	1.04	1.03	1 X 1/2 X 3/4"	1.37	1.22	1.45
1/2 X 1/2 X 1/4"	0.97	0.97	0.98	1 X 1/2 X 1/2"	1.26	1.12	1.36
1/2 X 3/8 X 1/2"	1.12	1.03	1.12	3/4 X 3/4 X 1"	1.45	1.45	1.37
1/2 X 3/8 X 3/8"	1.04	0.95	1.03	1/2 X 1/2 X 1"	1.36	1.36	1.26
1/2 X 1/4 X 1/2"	1.12	0.98	1.12	1 1/4 X 1 1/4 X 1"	1.58	1.58	1.67
3/8 X 3/8 X 1/2"	1.03	1.03	1.04	1 1/4 X 1 1/4 X 3/4"	1.45	1.45	1.62
3/4 X 3/4 X 1/2"	1.20	1.20	1.22	1 1/4 X 1 1/4 X 1/2"	1.34	1.34	1.53
3/4 X 3/4 X 3/8"	1.12	1.12	1.13	1 1/4 X 1 1/4 X 3/8"	1.26	1.26	1.44
3/4 X 3/4 X 1/4"	1.05	1.05	1.08	1 1/4 X 1 X 1 1/4"	1.75	1.67	1.75
3/4 X 1/2 X 3/4"	1.31	1.22	1.31	1 1/4 X 1 X 1"	1.58	1.50	1.67
3/4 X 1/2 X 1/2"	1.20	1.12	1.22	1 1/4 X 1 X 3/4"	1.45	1.37	1.62
3/4 X 1/2 X 3/8"	1.12	1.04	1.13	1 1/4 X 1 X 1/2"	1.34	1.26	1.53
3/4 X 3/8 X 3/4"	1.31	1.13	1.31	1 1/4 X 3/4 X 1 1/4"	1.75	1.62	1.75
3/4 X 3/8 X 3/8"	1.12	0.95	1.13	1 1/4 X 3/4 X 1"	1.58	1.45	1.67
3/4 X 1/4 X 3/4"	1.31	1.08	1.31	1 1/4 X 3/4 X 3/4"	1.45	1.31	1.62
1/2 X 1/2 X 3/4"	1.22	1.22	1.20	1 1/4 X 1/2 X 1 1/4"	1.75	1.53	1.75
1 X 1 X 3/4"	1.37	1.37	1.45	1 1/4 X 1/2 X 1"	1.58	1.36	1.67

Fig No. 14 - REDUCING TEES BANDED (BRT)

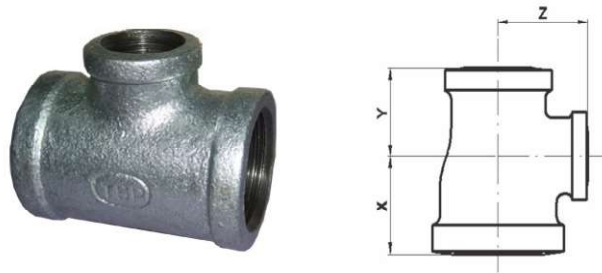

Dimension of Class 150 - (in Inch)							
SIZE	X	Y	Z	SIZE	X	Y	Z
1 X 1 X 1¼"	1.67	1.67	1.58	2 X 1½ X 1½"	2.02	1.94	2.16
¾ X ¾ X 1 ¼"	1.62	1.62	1.45	2 X 1½ X 1¼"	1.90	1.82	2.10
1 ½ X 1 ½ X 1¾"	1.82	1.82	1.88	2 X 1½ X 1"	1.73	1.65	2.02
1½ X 1½ X 1"	1.65	1.65	1.80	2 X 1¼ X 2"	2.25	2.10	2.25
1½ X 1½ X ¾"	1.52	1.52	1.75	2 X 1¼ X 1½"	2.02	1.88	2.16
1½ X 1½ X 1/2"	1.41	1.41	1.66	2 X 1¼ X 1¼"	1.90	1.75	2.10
1½ X 1¼ X 1½"	1.94	1.88	1.94	2 X 1 X 2"	2.25	2.02	2.25
1½ X 1¼ X 1¼"	1.82	1.75	1.88	2 X 1 X 1½"	2.02	1.80	2.16
1½ X 1¼ X 1"	1.65	1.58	1.80	2 X ¾ X 2"	2.25	1.97	2.25
1½ X 1¼ X ¾"	1.52	1.45	1.75	2 X 1/2 X 2"	2.25	1.88	2.25
1½ X 1¼ X 1/2"	1.41	1.34	1.66	1½ X 1½ X 2"	2.16	2.16	2.02
1½ X 1 X 1½"	1.94	1.80	1.94	1¼ X 1¼ X 2"	2.10	2.10	1.90
1½ X 1 X 1¼"	1.82	1.67	1.88	1 X 1 X 2"	2.02	2.02	1.73
1½ X 1 X 1"	1.65	1.50	1.80	2½ X 2½ X 2"	2.39	2.39	2.60
1½ X ¾ X 1½"	1.94	1.75	1.94	2½ X 2½ X 1½"	2.16	2.16	2.51
1½ X ½ X 1½"	1.94	1.66	1.94	2½ X 2½ X 1¼"	2.04	2.04	2.45
1¼ X 1¼ X 1½"	1.88	1.88	1.82	2½ X 2½ X 1"	1.87	1.87	2.37
1 X 1 X 1½"	1.80	1.80	1.65	2½ X 2½ X ¾"	1.74	1.74	2.32
2 X 2 X 1½"	2.02	2.02	2.16	2½ X 2 X 2½"	2.70	2.60	2.70
2 X 2 X 1¼"	1.90	1.90	2.10	2½ X 2 X 2"	2.39	2.25	2.60
2 X 2 X 1"	1.73	1.73	2.02	2½ X 1½ X 2½"	2.70	2.51	2.70
2 X 2 X ¾"	1.60	1.60	1.97	2½ X 1½ X 2"	2.39	2.16	2.60
2 X 2 X 1/2"	1.49	1.49	1.88	2 X 2 X 2½"	2.60	2.60	2.39
2 X 1½ X 2"	2.25	2.16	2.25	3 X 3 X 2½"	2.83	2.83	2.99

Fig No. 14 - REDUCING TEES BANDED (BRT)

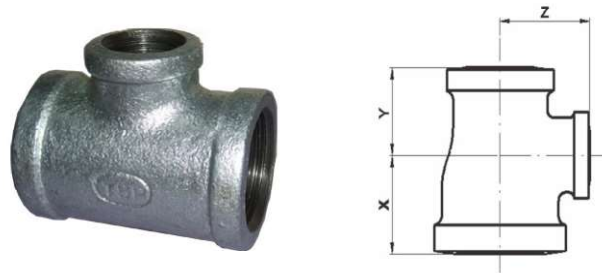

Dimension of Class 150 - (in Inch)							
SIZE	X	Y	Z	SIZE	X	Y	Z
3 X 3 X 2"	2.52	2.52	2.89	4 X 4 X 3"	3.30	3.30	3.60
3 X 3 X 1 1/2"	2.29	2.29	2.80	4 X 4 X 2 1/2"	3.05	3.05	3.51
3 X 3 X 1 1/4"	2.17	2.17	2.74	4 X 4 X 2"	2.74	2.74	3.41
3 X 3 X 1"	2.00	2.00	2.66	4 X 4 X 1 1/2"	2.51	2.51	3.32
3 X 3 X 3/4"	1.87	1.87	2.61	4 X 3 X 4"	3.79	3.60	3.79
3 X 2 1/2 X 3"	3.08	2.99	3.08	3 X 3 X 4"	3.60	3.60	3.30
3 X 2 1/2 X 2 1/2"	2.83	2.70	2.99				
3 X 2 1/2 X 2"	2.52	2.39	2.89				
3 X 2 X 3"	3.08	2.89	3.08				
3 X 2 X 2"	2.52	2.25	2.89				
2 1/2 X 2 1/2 X 3"	2.99	2.99	2.83				

Dimension of Class 300 - (in Inch)							
SIZE	X	Y	Z	SIZE	X	Y	Z
3/4 X 3/4 X 1/2"	1.31	1.31	1.38	1 1/2 X 1 1/2 X 1"	1.81	1.81	2.00
1 X 1 X 1/2"	1.44	1.44	1.50	1 1/2 X 1 1/2 X 1 1/4"	2.00	2.00	2.06
1 X 1 X 3/4"	1.50	1.50	1.56	2 X 2 X 1 1/2"	1.75	1.75	2.06
1 1/4 X 1 1/4 X 1/2"	1.50	1.50	1.69	2 X 2 X 3/4"	1.81	1.81	2.13
1 1/4 X 1 1/4 X 3/4"	1.63	1.63	1.75	2 X 2 X 1"	2.00	2.00	2.25
1 1/4 X 1 1/4 X 1"	1.75	1.75	1.81	2 X 2 X 1 1/4"	2.13	2.13	2.31
1 1/2 X 1 1/2 X 1/2"	1.63	1.63	1.81	2 X 2 X 1 1/2"	2.25	2.25	2.38
1 1/2 X 1 1/2 X 3/4"	1.69	1.69	1.88				

Note : For dimensions not given, see the dimensions table of Tees

Fig No. 19A - CROSSES (BCR)

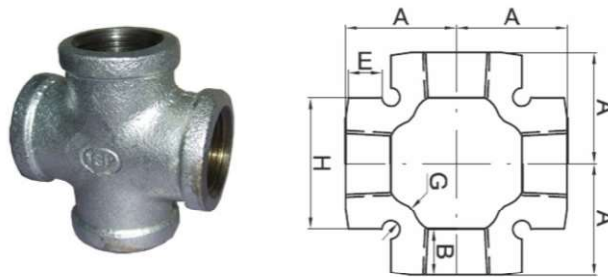

Dimension of Class 150 - (in Inch)					
SIZE	A	B (min)	E (min)	G	H (min)
1/4"	0.81	0.32	0.21	0.09	0.84
3/8"	0.95	0.36	0.23	0.10	1.01
1/2"	1.12	0.43	0.25	0.10	1.20
3/4"	1.31	0.50	0.27	0.12	1.46
1"	1.50	0.58	0.30	0.13	1.77
1 1/4"	1.75	0.67	0.34	0.14	2.15
1 1/2"	1.94	0.70	0.37	0.15	2.43
2"	2.25	0.75	0.42	0.17	2.96
2 1/2"	2.70	0.92	0.48	0.21	3.59
3"	3.08	0.98	0.55	0.23	4.28
3 1/2"	3.42	1.03	0.60	0.25	4.84
4"	3.79	1.08	0.66	0.26	5.40
5"	4.50	1.18	0.78	0.30	6.58
6"	5.13	1.28	0.90	0.34	7.77

Fig No. 21A - ROUND CAPS BANDED (RC)

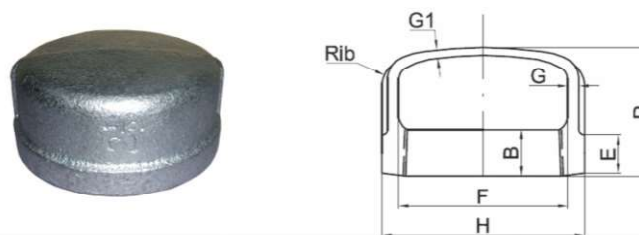

Dimension of Class 150 - (in Inch)									
SIZE	B (min)	E (min)	F		G	H (min)	P (min)	Ribs	G1
			Min	Max					
1/4"	0.32	0.21	0.54	0.58	0.09	0.84	0.63	-	-
3/8"	0.36	0.23	0.67	0.72	0.10	1.01	0.74	-	-
1/2"	0.43	0.25	0.84	0.90	0.10	1.20	0.87	0.10	-
3/4"	0.50	0.27	1.05	1.11	0.12	1.46	0.97	0.12	0.13
1"	0.58	0.30	1.31	1.38	0.13	1.77	1.16	0.13	0.15

Fig No. 21A - ROUND CAPS BANDED (RC)

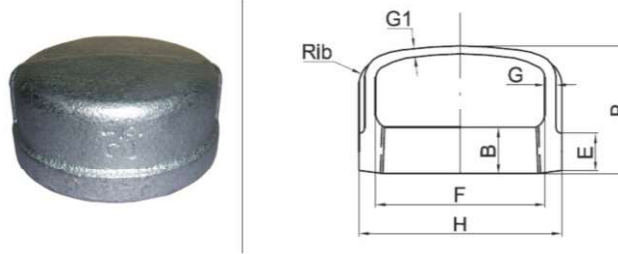

Dimension of Class 150 - (in Inch)									
SIZE	B (min)	E (min)	F		G	H (min)	P (min)	Ribs	G1
			Min	Max					
1¼"	0.67	0.34	1.66	1.73	0.14	2.15	1.28	0.14	0.17
1½"	0.70	0.37	1.90	1.97	0.15	2.43	1.33	0.15	0.19
2"	0.75	0.42	2.37	2.44	0.17	2.46	1.45	0.17	0.22
2½"	0.92	0.48	2.87	2.97	0.21	3.59	1.70	0.21	0.25
3"	0.98	0.55	3.50	3.60	0.23	4.28	1.80	0.23	0.29
3½"	1.03	0.60	4.00	4.10	0.25	4.84	1.90	0.25	0.30
4"	1.08	0.66	4.50	4.60	0.26	5.40	2.08	0.26	0.36
5"	1.18	0.78	5.56	5.66	0.30	6.58	2.32	0.30	-
6"	1.28	0.90	6.62	6.72	0.34	7.77	2.55	0.34	-

Dimension of Class 300 - (in Inch)									
SIZE	B (min)	E (min)	F		G	H (min)	P (min)	G1	
			Min	Max					
1/2"	0.57	0.50	0.84	0.90	0.16	1.34	0.98	0.20	
3/4"	0.64	0.56	1.05	1.11	0.18	1.63	1.08	0.23	
1"	0.75	0.62	1.31	1.38	0.20	1.95	1.26	0.25	
1¼"	0.84	0.69	1.66	1.73	0.22	2.39	1.38	0.28	
1½"	0.87	0.75	1.90	1.97	0.24	2.68	1.43	0.30	
2"	1.00	0.84	2.37	2.44	0.26	3.28	1.68	0.33	
2½"	1.17	0.94	2.87	2.97	0.31	3.86	2.06	0.39	
3"	1.23	1.00	3.50	3.60	0.35	4.62	2.17	0.44	

Fig No. 24B - COUPLINGS BANDED (BS)

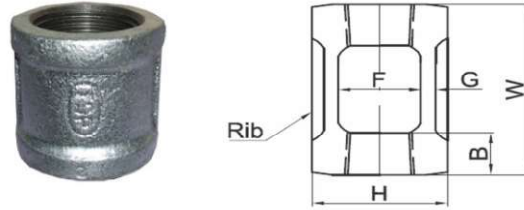

Dimension of Class 150 - (in Inch)							
SIZE	B (min)	F		G	H (min)	Ribs	W
		Min	Max				
1/8"	0.25	0.4	0.43	0.09	0.69	0.09	0.96
1/4"	0.32	0.54	0.58	0.09	0.84	0.09	1.06
3/8"	0.36	0.67	0.72	0.10	1.01	0.10	1.16
1/2"	0.43	0.84	0.90	0.10	1.20	0.10	1.34
3/4"	0.50	1.05	1.11	0.12	1.46	0.12	1.52
1"	0.58	1.31	1.38	0.13	1.77	0.13	1.67
1¼"	0.67	1.66	1.73	0.14	2.15	0.14	1.93
1½"	0.70	1.90	1.97	0.15	2.43	0.15	2.15
2"	0.75	2.37	2.44	0.17	2.96	0.17	2.53
2½"	0.92	2.87	2.97	0.21	3.59	0.21	2.88
3"	0.98	3.50	3.60	0.23	4.28	0.23	3.18
4"	1.08	4.50	4.60	0.26	5.40	0.26	3.69

Dimension of Class 300 - (in Inch)							
SIZE	B (min)	F		G	H (min)	Ribs	W
		Min	Max				
1/2"	0.57	0.84	0.90	0.16	1.34	0.16	1.87
3/4"	0.64	1.05	1.11	0.18	1.63	0.18	2.12
1"	0.75	1.31	1.38	0.20	1.95	0.20	2.37
1¼"	0.84	1.66	1.73	0.22	2.39	0.22	2.87
1½"	0.87	1.90	1.97	0.24	2.68	0.24	2.87
2"	1.00	2.37	2.44	0.26	3.28	0.26	3.62

Fig No. 26 - REDUCING COUPLINGS BANDED (BRS)

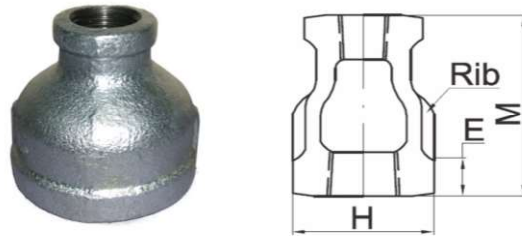

Dimension of Class 150 - (in Inch)				
SIZE	E (min)	H (min)	Ribs	M
1/4"	0.21	0.84	0.09	1.00
3/8"	0.23	1.01	0.10	1.13
1/2"	0.25	1.20	0.10	1.25
3/4"	0.27	1.46	0.12	1.44
1"	0.30	1.77	0.13	1.69
1¼"	0.34	2.15	0.14	2.06
1½"	0.37	2.43	0.15	2.31
2"	0.42	2.96	0.17	2.81
2½"	0.48	3.59	0.21	3.25
3"	0.55	4.28	0.23	3.69
4"	0.66	5.40	0.26	4.38

Dimension of Class 300 - (in Inch)				
SIZE	E (min)	H (min)	Ribs	M
1/4"	0.38	0.93	0.14	1.69
3/8"	0.44	1.12	0.15	1.44
1/2"	0.50	1.34	0.16	1.69
3/4"	0.56	1.63	0.18	1.75
1"	0.62	1.95	0.20	2
1¼"	0.69	2.39	0.22	2.38
1½"	0.75	2.68	0.24	2.69
2"	0.84	3.28	0.26	3.19

Note : For dimensions not given, see the dimensions table of Sockets

Fig No. 29 - LOCKNUTS (LN)

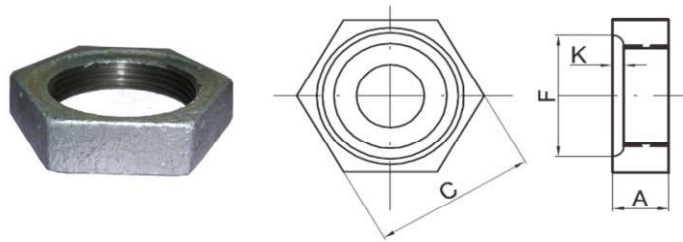

Dimension of Class 150 - (in Inch)				
SIZE	A (min)	C (min)	F (min)	K
1/4"	0.25	0.84	0.66	0.06
3/8"	0.28	1.00	0.77	0.06
1/2"	0.31	1.18	0.97	0.06
3/4"	0.34	1.43	1.23	0.06
1"	0.38	1.75	1.50	0.06
1 ¼"	0.42	2.10	1.86	0.06
1 ½"	0.47	2.35	2.12	0.06
2"	0.53	2.88	2.63	0.09
2 ½"	0.59	3.50	3.18	0.09
3"	0.67	4.27	3.84	0.09
3 ½"	0.73	4.84	4.38	0.13
4"	0.80	5.38	5.00	0.13

Fig No. 32 - NIPPLES (N)

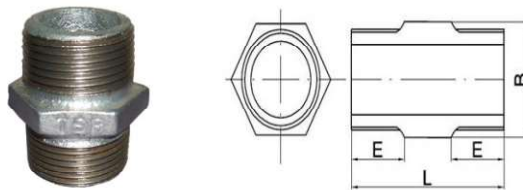

Dimension of Class 150 - (in Inch)				
SIZE	E	N	L	FEATURE
1/2"	0,63	0,51	1,65	OCTAGON
3/4"	0,71	0,71	1,85	OCTAGON
1"	0,79	0,94	2,05	OCTAGON
1 ¼"	0,87	1,26	2,20	OCTAGON
1 ½"	0,91	1,46	2,36	OCTAGON
2"	0,98	1,89	2,60	DECAGON

NOTE : REFERENCE STANDARD JIS B.2301

Fig No. 30 - BUSHINGS (HB)

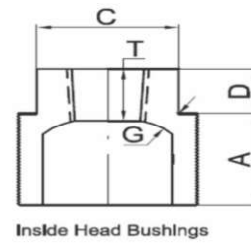
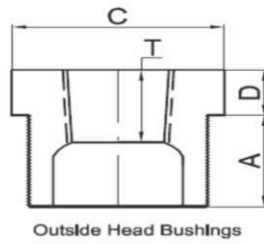

Dimension of Class 150 - (in Inch)						
SIZE	A (min)	T (min)	D (min)	C (min)		G
				Outside	Inside	
1/4 X 1/8"	0.44	0.26	0.14	0.64	-	-
3/8 X 1/4"	0.48	0.40	0.16	0.68	-	-
3/8 X 1/8"	0.48	0.25	0.16	0.68	-	-
1/2 X 3/8"	0.56	0.41	0.19	0.87	-	-
1/2 X 1/4"	0.56	0.32	0.19	0.87	-	-
1/2 X 1/8"	0.56	0.25	0.19	0.87	-	-
3/4 X 1/2"	0.63	0.53	0.22	1.15	-	-
3/4 X 3/8"	0.63	0.36	0.22	1.15	-	-
3/4 X 1/4"	0.63	0.32	0.22	1.15	-	-
3/4 X 1/8"	0.63	0.25	0.22	1.15	-	-
1 X 3/4"	0.75	0.50	0.25	1.42	-	-
1 X 1/2"	0.75	0.43	0.25	1.42	-	-
1 X 3/8"	0.75	0.36	0.30	-	1.12	-
1 X 1/4"	0.75	0.32	0.30	-	1.12	-
1 X 1/8"	0.75	0.25	0.30	-	1.12	-
1 ¼ X 1"	0.80	0.58	0.28	1.76	-	-
1 ¼ X 3/4"	0.80	0.50	0.28	1.76	-	-
1 ¼ X 1/2"	0.80	0.43	0.24	-	1.34	0.18
1 ¼ X 3/8"	0.80	0.36	0.34	-	1.12	0.18
1 ¼ X 1/4"	0.80	0.32	0.34	-	1.12	0.18
1 ½ X 1 ¼"	0.83	0.77	0.31	2.00	-	-
1 ½ X 1"	0.83	0.58	0.31	2.00	-	-
1 ½ X 3/4"	0.83	0.50	0.37	-	1.63	0.20
1 ½ X 1/2"	0.83	0.43	0.37	-	1.34	0.20
1 ½ X 3/8"	0.83	0.36	0.37	-	1.12	0.20
1 ½ X 1/4"	0.83	0.32	0.37	-	1.12	0.20
2 X 1 ½"	0.88	0.70	0.34	2.48	-	-
2 X 1 ¼"	0.88	0.67	0.34	2.48	-	-
2 X 1"	0.88	0.58	0.41	-	1.95	0.22

Fig No. 30 - BUSHINGS (HB)

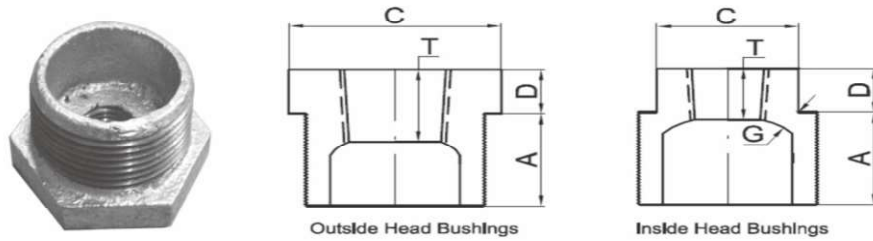

Dimension of Class 150 - (in Inch)						
SIZE	A (min)	T (min)	D (min)	C (min)		G
				Outside	Inside	
2 X 3/4"	0.88	0.50	0.41	-	1.63	0.22
2 X 1/2"	0.88	0.43	0.41	-	1.34	0.22
2 X 3/8"	0.88	0.36	0.41	-	1.12	0.22
2 X 1/4"	0.88	0.32	0.41	-	1.12	0.22
2 1/2 X 2"	1.07	0.75	0.37	2.98	-	-
2 1/2 X 1 1/2"	1.07	0.70	0.44	2.68	-	-
2 1/2 X 1 1/4"	1.07	0.67	0.44	-	2.39	0.24
2 1/2 X 1"	1.07	0.58	0.44	-	1.95	0.24
2 1/2 X 3/4"	1.07	0.50	0.44	-	1.63	0.24
2 1/2 X 1/2"	1.07	0.43	0.44	-	1.34	0.24
3 X 2 1/2"	1.13	0.92	0.40	3.86	-	-
3 X 2"	1.13	0.75	0.48	3.28	-	-
3 X 1 1/2"	1.13	0.70	0.48	-	2.68	0.26
3 X 1 1/4"	1.13	0.67	0.48	-	2.39	0.26
3 X 1"	1.13	0.58	0.48	-	1.95	0.26
3 X 3/4"	1.13	0.50	0.48	-	1.63	0.26
3 X 1/2"	1.13	0.43	0.48	-	1.34	0.26
4 X 3"	1.22	0.98	0.50	4.62	-	-
4 X 2 1/2"	1.22	0.92	0.60	-	3.86	0.31
4 X 2"	1.22	0.75	0.60	-	3.28	0.31
4 X 1 1/2"	1.22	0.70	0.60	-	2.68	0.31
4 X 1 1/4"	1.22	0.67	0.60	-	2.39	0.31
4 X 1"	1.22	0.58	0.60	-	1.95	0.31
6 X 5"	1.40	1.18	0.63	7.05	-	-
6 X 4"	1.40	1.08	0.75	-	5.79	0.43
6 X 3"	1.40	0.98	0.75	-	4.62	0.43
6 X 2 1/2"	1.40	0.92	0.75	-	3.86	0.43
6 X 2"	1.40	0.75	0.75	-	3.28	0.43

Fig No. 31A - SQUARE HEAD PLUGS (P SQUARE)

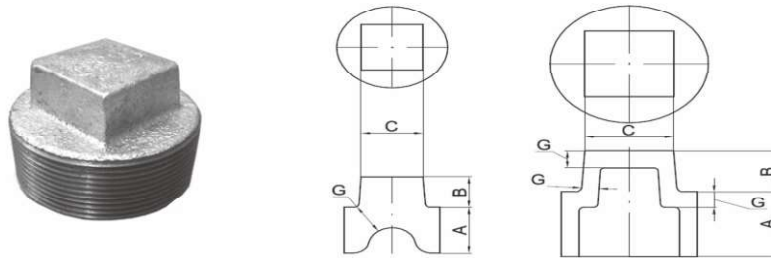

Dimension of Class 150 - (in Inch)				
SIZE	A (min)	B (min)	C	G
1/4"	0.44	0.28	3/8	-
3/8"	0.48	0.31	7/16	-
1/2"	0.56	0.38	9/16	0.16
3/4"	0.63	0.44	5/8	0.18
1"	0.75	0.50	13/16	0.20
1 1/4"	0.80	0.56	15/16	0.22
1 1/2"	0.83	0.62	1-1/8	0.24
2"	0.88	0.68	1-5/16	0.26
2 1/2"	1.07	0.74	1-1/2	0.29
3"	1.13	0.80	1-1 1/16	0.31

Fig No. 31B - SLOTTED HEAD PLUGS (P SLOTTED)

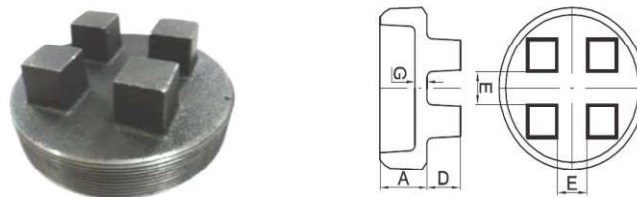

Dimension of Class 150 - (in Inch)				
SIZE	A (min)	D (min)	E (min)	G
4"	1.22	1.00	0.88	0.37
5"	1.31	1.00	0.88	0.46
6"	1.40	1.25	1.25	0.52
8"	1.57	1.38	1.50	0.66

Fig No. 35B - UNIONS FEMALE CONICAL JOINT BRASS TO IRON SEAT (CU BRASS)

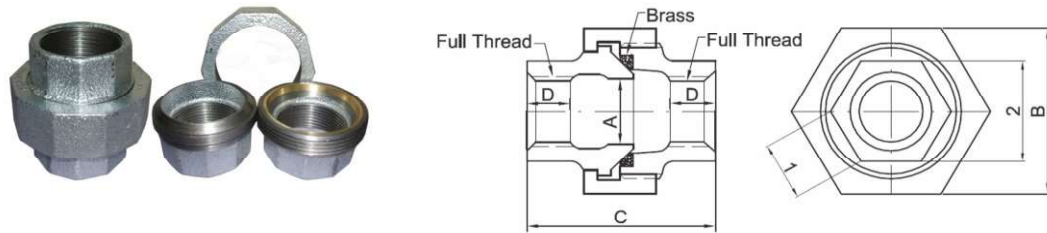

Dimension of Class 150 - (in Inch)							
SIZE	A (min)	B (min)	C (min)	D (min)	1	2	FEATURE
1/4"	0.36	1.10	1.44	0.40	0.41	0.72	HEXAGON
3/8"	0.52	1.26	1.61	0.41	0.51	0.88	HEXAGON
1/2"	0.61	1.45	1.72	0.53	0.44	1.07	OCTAGON
3/4"	0.80	1.71	1.94	0.55	0.53	1.27	OCTAGON
1"	1.00	2.07	2.06	0.68	0.64	1.56	OCTAGON
1¼"	1.31	2.50	2.26	0.71	0.63	1.92	DECAGON
1½"	1.55	2.82	2.41	0.72	0.71	2.20	DECAGON
2"	2.03	3.41	2.75	0.76	0.88	2.72	DECAGON
2½"	2.38	4.12	3.22	1.14	1.07	3.30	DECAGON
3"	3.00	4.75	3.50	1.20	1.28	3.90	DECAGON
4"	4.03	6.00	3.85	1.30	1.62	5.00	DECAGON

Dimension of Class 300 - (in Inch)							
SIZE	A (min)	B (min)	C (min)	D (min)	1	2	FEATURE
1/4"	0.30	1.34	1.56	0.43	0.43	0.43	HEXAGON
3/8"	0.41	1.50	1.71	0.47	0.54	0.97	HEXAGON
1/2"	0.53	1.75	1.81	0.57	0.45	1.09	OCTAGON
3/4"	0.75	2.15	2.13	0.65	0.55	1.33	OCTAGON
1"	0.94	2.48	2.30	0.75	0.56	1.72	DECAGON
1¼"	1.28	3.01	2.66	0.85	0.67	2.06	DECAGON
1½"	1.50	3.29	2.85	0.87	0.74	2.26	DECAGON
2"	1.93	3.96	3.23	1.00	0.93	2.85	DECAGON
2½"	2.32	4.72	3.31	1.16	1.13	3.46	DECAGON
3"	2.89	5.37	4.11	1.22	1.29	3.98	DECAGON

Fig No. 35C - UNION FEMALE CONICAL JOINT IRON TO IRON SEAT (CU)

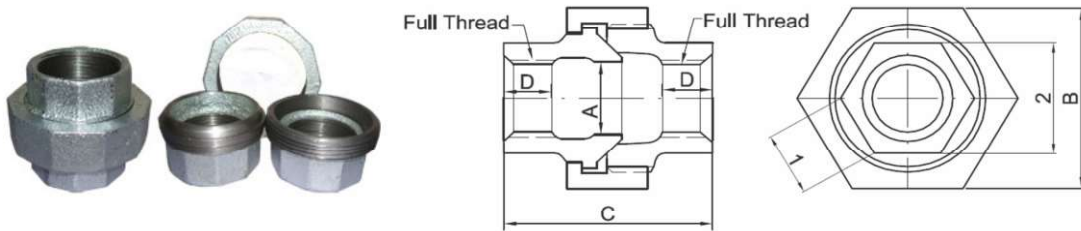

Dimension of Class 150 - (in Inch)							
SIZE	A (min)	B (min)	C (min)	D (min)	1	2	FEATURE
1/4"	0.36	1.10	1.44	0.40	0,41	0,72	HEXAGON
3/8"	0.52	1.26	1.61	0.41	0,51	0,88	HEXAGON
1/2"	0.61	1.45	1.72	0.53	0,44	1,07	OCTAGON
3/4"	0.80	1.71	1.94	0.55	0,53	1,27	OCTAGON
1"	1.00	2.07	2.06	0.68	0,64	1,56	OCTAGON
1¼"	1.31	2.50	2.26	0.71	0,63	1,92	DECAGON
1½"	1.55	2.82	2.41	0.72	0,71	2,20	DECAGON
2"	2.03	3.41	2.75	0.76	0,88	2,72	DECAGON
2½"	2.38	4.12	3.22	1.14	1,07	3,30	DECAGON
3"	3.00	4.75	3.50	1.20	1,28	3,90	DECAGON
4"	4.03	6.00	3.85	1.30	1,62	5,00	DECAGON

FLOOR FLANGES

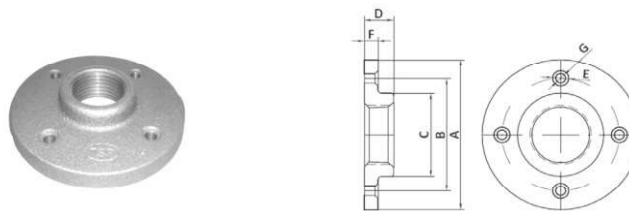

Dimension of Class 150 - (in Inch)							
SIZE	A	B	C	D	E	F	G
1/2"	3.48	2.50	1.12	0.51	0.39	0.28	0.26
3/4"	3.48	2.50	1.38	0.59	0.39	0.28	0.26
1"	4.02	3.00	1.79	0.71	0.41	0.35	0.26
1¼"	4.02	3.00	2.20	0.75	0.41	0.35	0.26
1½"	4.49	3.50	2.30	0.85	0.59	0.37	0.31
2"	5.49	4.25	2.81	0.98	0.59	0.39	0.31