

Building connections that last™



Lead Free Products





Lead Free Products

Brass and Stainless Valves, Bronze Fittings, Brass Nipples & Pipe;
Galvanized Malleable Iron Fittings & Steel Pipe Nipples

**All Smith-Cooper Lead Free Products are fully compliant with the
2014 Federal Safe Water Drinking Act (SWDA) -
US Senate Bill S 3874 & California AB 1953**

Lead Free Products

- Galvanized malleable iron fittings are certified to; NSF/ANSI 372, SWDA and California AB1953 Lead Free
- Galvanized steel nipples are certified to; NSF/ANSI 372, SWDA and California AB1953 Lead Free
- Red brass seamless nipples and pipe are certified to SWDA and California AB 1953 Lead Free
- Lead free valves are certified to; NSF/ANSI 372, SWDA and California AB1953 Lead Free
- Lead free bronze fittings are certified to; NSF/ANSI 372, SWDA and California AB1953 Lead Free

Lead Free Bronze Fitting Specifications

- Bronze fittings conform to AWWA C800
- Bronze castings manufactured from ASTM B584 UNS Alloy C89833 ingot
- Bronze fitting dimensions conform to ASME B16.15, Class125
- NPT threads on all fittings conform to ASME B1.20.1
- Bronze unions conform to specification A-A-59617
- Manufacturing facilities are ISO 9001:2008
- Thread protectors on all male threads
- Fittings have SCI trademark and are 100% air tested
- Certified to ANSI/NSF 372, SWDA and California AB 1953
- ProPak™ Packaging



Series 8170L & 8171L Brass Ball Valve

- Certified to SWDA and California AB1953
- Certified to NSF/ANSI 372
- Full port
- Forged brass body
- Blow-out proof stem
- Chrome plated ball
- 600 lb. CWP, 150 lb. WSP up to 2"
- 400 lb. CWP, 150 lb. WSP 2 1/2" - 4"
- UL Listed (1/4" - 2") threaded
- F/M Approved, (1/2" - 2")
- CSA Approved under z21.15a for 1/2 psig (1/2" - 2") - threaded
- CSA Approved under 3-88 for 5 psig (1/2" - 2") - threaded
- Approved under ANSI/ASME B16.33 spec for Gas Piping to 125 psig (1/2" - 2")
- Meets Fed Spec WW-V-35, Type II, Class A, Style 3 (1/2" - 2")
- Conforms to MSS-SP110
- ISO 9001:2008 manufacturer



Size in	Part Number		Packing		Weight lb
	Threaded	Sweat	Inner	Master	
1/4	01728170CL	-	10	160	0.4
3/8	01728170EL	-	10	160	0.3
1/2	01728170GL	01728171GL	10	120	0.5
3/4	01728170IL	01728171IL	6	72	0.7
1	01728170KL	01728171KL	4	48	1.0
1-1/4	01728170LL	01728171LL	4	24	1.7
1-1/2	01728170ML	01728171ML	6	18	2.3
2	01728170NL	01728171NL	4	8	3.5
2-1/2	01728170PL	-	2	6	6.9
3	01728170QL	-	2	4	8.5
4	01728170TL	-	-	2	16.6

Series 8175L & 8176L Brass Ball Valve with Drain

- Certified to SWDA and California AB1953
- Certified to NSF/ANSI 372
- 600 lb. CWP
- Full port
- Blow-out proof stem
- Forged brass body
- PTFE seats and seals
- Fed. Spec. WW-V-35, Type II, Class A Style 3
- Conforms to MSS SP-110
- ISO 9001:2008 manufacturer



Size in	Part Number		Packing		Weight lb
	Threaded	Sweat	Inner	Master	
1/2	01728175GL	01728176GL	10	100	0.5
3/4	01728175IL	01728176IL	8	48	0.9
1	01728175KL	01728176KL	5	30	1.4

Series 8155L & 8156L Brass Ball Valve

- Certified to SWDA and California AB1953
- Certified to NSF/ANSI 61-8
- 600 lb. CWP, 150 lb. WSP up to 2"
- 400 lb. CWP, 150 lb. WSP 2 1/2" - 4"
- Full port
- Forged brass body
- Chrome plated ball
- PTFE seats and seals
- Blow-out proof stem
- CSA Approved (1/2" thru 2") - Threaded
- ISO 9001:2008 manufacturer



Size in	Part Number		Packing		Weight lb
	Threaded	Sweat	Inner	Master	
1/4	01728155CL	-	10	160	0.3
3/8	01728155EL	-	10	160	0.3
1/2	01728155GL	01728156GL	10	120	0.5
3/4	01728155IL	01728156IL	10	60	0.7
1	01728155KL	01728156KL	6	60	1.0
1-1/4	01728155LL	01728156LL	4	24	1.7
1-1/2	01728155ML	01728156ML	4	16	2.3
2	01728155NL	01728156NL	2	16	3.5
2-1/2	01728155PL	01728156PL	2	6	6.8
3	01728155QL	01728156QL	2	4	8.5
4	01728155TL	01728156TL	1	2	16.0

Series 8160L Nickel Plated Brass Ball Valve

- Certified to SWDA and California AB1953
- Certified to NSF/ANSI 61-8
- 600 lb. CWP, 150 lb WSP
- Full port
- Forged brass body, nickel plated
- Chrome plated ball
- Blow-out proof stem
- CSA Approved (1/2" - 2")
- ISO 9001:2008 manufacturer



Size in	Part Number		Packing		Weight lb
	Threaded	Sweat	Inner	Master	
1/8	01728160AL	-	10	160	0.3
1/4	01728160CL	-	10	160	0.3
3/8	01728160EL	-	10	160	0.3
1/2	01728160GL	-	10	120	0.5
3/4	01728160IL	-	10	60	0.7
1	01728160KL	-	6	60	1.0
1-1/4	01728160LL	-	4	24	1.7
1-1/2	01728160ML	-	4	16	2.3
2	01728160NL	-	2	16	3.5

LEAD FREE

**Series 8135L
Brass Ball Valve**

- Certified to SWDA and California AB1953
- Certified to NSF/ANSI 372
- 400 lb. CWP, 150 lb. WSP
- Standard port
- Forged brass body
- Chrome plated ball
- PTFE seats and seals
- Blow-out proof stem
- Certified to NSF/ANSI 61-8
- ISO 9001:2008 manufacturer



Size in	Part Number	Packing		Weight lb
	Threaded	Inner	Master	
1/4	01728135CL	12	120	0.3
3/8	01728135EL	12	120	0.3
1/2	01728135GL	12	120	0.4
3/4	01728135IL	8	96	0.5
1	01728135KL	8	48	0.9
1-1/4	01728135LL	8	32	1.1
1-1/2	01728135ML	4	24	1.7
2	01728135NL	2	16	2.4

**Series 8145L & 8146L
Brass Ball Valve**

- Certified to SWDA and California AB1953
- Certified to NSF/ANSI 372
- 600 lb. CWP, 150 lb. WSP
- Full port
- Forged brass body
- Chrome plated ball
- PTFE seats and seals
- Blow-out proof stem
- ISO 9001:2008 manufacturer



Size in	Part Number		Packing		Weight lb
	Threaded	Sweat	Inner	Master	
1/4	01728145CL	-	12	120	0.4
3/8	01728145EL	-	12	120	0.4
1/2	01728145GL	01728146GL	8	96	0.4
3/4	01728145IL	01728146IL	6	72	0.6
1	01728145KL	01728146KL	6	36	0.9
1-1/4	01728145LL	01728146LL	6	24	1.3
1-1/2	01728145ML	01728146ML	2	16	2.0
2	01728145NL	01728146NL	2	12	3.0



Fig. QBBV - Valve

Size in	Part Number	Packing		Weight lb
		Inner	Master	
1/2	QBBV004	10	20	0.408
3/4	QBBV006	10	20	0.598
1	QBBV010	5	10	1.152

**Series 8183L
Brass Ball Valve**

- Certified to SWDA and California AB1953
- Forged brass body
- Pex ends
- Chrome plated ball
- PTFE seals
- ISO 9001:2008 manufacturer



Size in	Part Number	Packing		Weight lb
	Pex Ends	Inner	Master	
1/2	01728183GL	12	72	0.3
3/4	01728183IL	12	72	0.4
1	01728183KL	6	36	0.7

**Series 8184L
Brass Ball Valve**

- Certified to SWDA and California AB1953
- 400 lb. CWP, 150 lb. WSP
- Standard port
- Compression Ends
- Forged brass body
- Chrome plated ball
- PTFE seals
- ISO 9001:2008 manufacturer



Size in	Part Number	Packing		Weight lb
	Compression Ends	Inner	Master	
1/2	01728184GL	25	100	0.5
3/4	01728184IL	15	60	0.8
1	01728184KL	10	40	1.3

**Series 9101L
Bronze Gate Valve**

- Certified to SWDA and California AB1953
- Certified to NSF/ANSI 61-8
- 300 lb. CWP, 150 lb. WSP
- Full port (1/2 - 3)
- ASTM B-62 bronze
- Solid wedge disc
- Screwed in bonnet
- Non-rising stem
- Conforms to MSS SP-80
- Cast iron star handle
- ISO 9001:2008 manufacturer

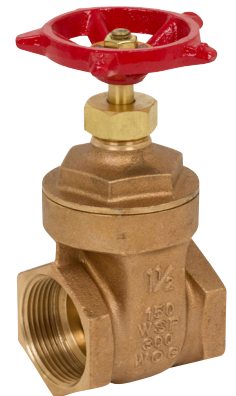

Size in	Part Number	Packing		Weight lb
	Threaded	Inner	Master	
1/2	01719101GL	12	72	0.6
3/4	01719101IL	3	18	1.0
1	01719101KL	5	40	1.3
1-1/4	01719101LL	3	18	1.9
1-1/2	01719101ML	6	24	2.3
2	01719101NL	4	16	3.5

LEAD FREE

Lead Free Valves

Series 8501L & 8502L

Brass Gate Valve

- Certified to NSF/ANSI 372 Lead Free
- 200 lb. CWP
- Full port (1/4 - 3)
- Screwed in bonnet
- Non-rising brass stem
- Cast brass
- Metal to metal bonnet/body seating surfaces
- ISO 9001:2008 manufacturer



Size in	Part Number		Packing		Weight lb
	Threaded	Sweat	Inner	Master	
1/4	01718501CL	-	12	72	0.6
3/8	01718501EL	01718502EL	12	72	0.6
1/2	01718501GL	01718502GL	12	72	0.6
3/4	01718501IL	01718502IL	14	56	0.8
1	01718501KL	01718502KL	5	40	1.2
1-1/4	01718501LL	01718502LL	3	18	1.8
1-1/2	01718501ML	01718502ML	6	24	2.2
2	01718501NL	01718502NL	4	16	3.3
2-1/2	01718501PL	01718502PL	1	6	6.4
3	01718501QL	01718502QL	1	6	9.7
4	01718501TL	-	1	4	17.0

Series 8103L & 8104L

Brass Gate Valve with Drain

- Certified to NSF/ANSI 372 Lead Free
- 200 lb. CWP
- Full port
- Cast brass w/screwed in bonnet
- Solid wedge disc
- Non-rising stem
- Metal to metal bonnet/body seating surfaces
- ISO 9001:2008 manufacturer



Size in	Part Number		Packing		Weight lb
	Threaded	Sweat	Inner	Master	
1/2	01718103GL	01718104GL	12	72	0.72
3/4	01718103IL	01718104IL	14	56	1.18
1	01718103KL	01718104KL	8	32	1.26

Series 8130L

Brass Gate Valve with Compression Ends

- Certified to NSF/ANSI 372 Lead Free
- 200 lb. CWP
- Full port, Cast brass
- Screwed in bonnet
- Non-rising stem
- ISO 9001:2008 manufacturer



Size in	Part Number	Packing		Weight lb
	Compression Ends	Inner	Master	
1/2	01718130GL	10	60	0.8
3/4	01718130IL	10	40	1.0
1	01718130KL	8	32	1.4

Brass In-Line Check Valve

- Certified to NSF/ANSI 372 Lead Free
- Rated at 200 psi
- Cast brass
- EPDM seat and seal - CV30L
- Viton seat & seal - CV35L
- Spring loaded, stainless steel spring, opens at 2 psi



Size in	Part Number		Packing		Weight lb
	Threaded	Sweat	Inner	Master	
1/2	0209CV30GL	0209CV35GL	10	150	0.4
3/4	0209CV30IL	0209CV35IL	18	108	0.6
1	0209CV30KL	0209CV35KL	10	60	0.9
1-1/4	0209CV30LL	-	8	40	1.5
1-1/2	0209CV30ML	-	5	30	1.5
2	0209CV30NL	-	4	24	3.5

Series 9191L & 9192L

Brass Swing Check Valve

- Certified to SWDA and California AB1953
- Certified to NSF/ANSI 372 Lead Free
- 200 lb. CWP
- Cast brass
- Forged brass disc
- ISO 9001:2008 manufacturer



Size in	Part Number		Packing		Weight lb
	Threaded	Sweat	Inner	Master	
3/8	01739191EL	-	25	150	0.5
1/2	01739191GL	01739192GL	20	120	0.5
3/4	01739191IL	01739192IL	12	72	0.6
1	01739191KL	01739192KL	10	60	0.7
1-1/4	01739191LL	01739192LL	8	32	1.5
1-1/2	01739191ML	01739192ML	5	20	1.8
2	01739191NL	01739192NL	4	16	3
2-1/2	01739191PL	01739192PL	1	8	5.6
3	01739191QL	01739192QL	1	8	7.2
4	01739191TL	-	1	8	11.4

Series 7200L

Ground Key Stop & Drain

- Certified to SWDA and California AB1953
- Max 150 psi @ 100°F



Size in	Part Number	Packing		Weight lb
	Threaded	Inner	Master	
1/2	01767200GL	6	48	.9
3/4	01767200IL	6	48	1.0
1	01767200KL	4	32	2.0

**Series 130L
Brass Straight Stop**

- Certified to NSF/ANSI 372 Lead Free
- 125 lb. CWP
- Cast brass



Size in	Part Number		Packing		Weight lb
	Threaded		Inner	Master	
3/8	0190130EL		14	84	0.44

**Series 132L & 142L
Brass Straight Stop with
Stuffing Box**

- Certified to NSF/ANSI 372
- 125 lb. CWP
- Cast brass
- CSA Approved
- ISO 9001:2008 manufacturer



Size in	Part Number		Packing		Weight lb
	Threaded	Sweat	Inner	Master	
1/2	0190132GL	0190142GL	14	84	0.5
3/4	0190132IL	0190142IL	14	84	0.6

**Series 136L & 146L
Brass Straight Stop with Drain**

- Certified to NSF/ANSI 372
- 125 lb. CWP
- Cast brass
- CSA Approved
- ISO 9001:2008 manufacturer



Size in	Part Number		Packing		Weight lb
	Threaded	Sweat	Inner	Master	
1/2	0190136GL	0190146GL	14	84	0.5
3/4	0190136IL	0190146IL	12	84	0.6

**Brass Bent Nose Garden Valve,
FIP inlet**

- Certified to NSF/ANSI 372
- 125 lb. CWP
- Cast brass
- Oval handle



Size in	Part Number		Packing		Weight lb
	Threaded		Inner	Master	
3/4	0190170IL		12	72	0.7
1	0190170KL		12	72	0.7

**Series 6122
CPVC Ball Valve**

- Certified to SWDA and California AB1953
- Certified to NSF/ANSI 14
- Copper tube size
- 150 psi @ 180°F
- PTFE seat
- EPDM o-ring
- Cream body w/red handle
- Produced using virgin CPVC resins



Size in	Part Number		Packing		Weight lb
	Slip		Inner	Master	
1/2	02936122G		1	100	0.2
3/4	02936122I		1	100	0.2
1	02936122K		1	100	0.4

**Series 9521 & 9522
PVC Ball Valve**

- Certified to SWDA and California AB1953
- Certified to NSF/ANSI 14
- Schedule 40/80 PVC
- 150 psi @ 73°F
- Molded in place construction
- PTFE seat
- EPDM o-ring
- White w/blue handle
- Produced using virgin PVC resins



Size in	Part Number		Packing		Weight lb
	Threaded	Slip	Inner	Master	
1/2	02939521G	02939522G	1	80	0.2
3/4	02939521I	02939522I	1	45	0.3
1	02939521K	02939522K	1	25	0.6
1-1/4	02939521L	02939522L	1	20	0.7
1-1/2	02939521M	02939522M	1	14	1.0
2	02939521N	02939522N	1	8	1.5

**Series 9541 & 9542
PVC Ball Valve**

- Certified to SWDA and California AB1953
- Certified to NSF/ANSI 14
- Schedule 40/80 PVC
- 150 psi @ 73°F
- Molded in place construction
- Gray w/blue handle



Size in	Part Number		Packing		Weight lb
	Threaded	Slip	Inner	Master	
1/2	02939541G	02939542G	10	100	0.2
3/4	02939541I	02939542I	5	60	0.3
1	02939541K	02939542K	5	40	0.4
1-1/4	02939541L	02939542L	5	30	0.6
1-1/2	02939541M	02939542M	4	24	0.9
2	02939541N	02939542N	2	16	1.4

LEAD FREE

Stainless Ball Valves

Series SC101 316 Stainless Steel One-Piece Ball Valve

- 1000# CWP, 150# WSP
- Reduced Port
- Body: ASTM A351 GR CF8M (SS316)
- Ball: ASTM A351 GR CF8M (SS316)
- Stem: ASTM A276 T-316
- RTFE Seats
- Blow-Out Proof Stem
- Vacuum Service to 29" Hg
- Locking Handle
- MSS SP-110
- ISO 9001:2008 Manufacturer
- Lead Free

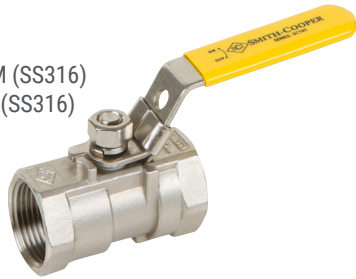

Size in	Part Number	Packing		Weight lb
	Threaded	Inner	Master	
1/4	SC101C	30	120	0.14
3/8	SC101E	18	72	0.21
1/2	SC101G	12	48	0.39
3/4	SC101I	10	40	0.49
1	SC101K	8	32	0.82
1-1/4	SC101L	8	16	1.16
1-1/2	SC101M	6	12	1.64
2	SC101N	4	8	2.59

Series SC201 316 Stainless Steel Two-Piece Ball Valve

- 1000# CWP, 150# WSP
- Full Port
- Body: ASTM A351 GR CF8M (SS316)
- Ball: ASTM A351 GR CF8M (SS316)
- Stem: ASTM A276 T-316
- RTFE Seats
- Blow-Out Proof Stem
- Vacuum Service to 29" Hg
- Locking Handle
- ISO 9001:2008 Manufacturer
- MSS SP-110
- Lead Free

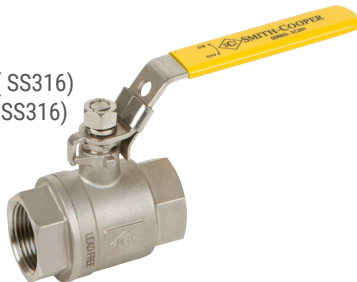

Size in	Part Number	Packing		Weight lb
	Threaded	Inner	Master	
1/4	SC201C	10	40	0.46
3/8	SC201E	10	40	0.46
1/2	SC201G	8	32	0.60
3/4	SC201I	12	24	0.87
1	SC201K	8	16	1.45
1-1/4	SC201L	6	12	2.13
1-1/2	SC201M	2	4	3.30
2	SC201N	2	4	5.70
2-1/2	SC201P	-	2	11.59
3	SC201Q	-	2	17.10

Series SC208 & SCL208 with Locking Handle 304 Stainless Steel Two-Piece Ball Valve

- 800# CWP, 150# WSP
- Full Port
- Body: ASTM A351 GR CF8 (SS304)
- Ball: ASTM A351 GR CF8 (SS304)
- Stem: ASTM A276 T-304
- RTFE Seats
- Blow-Out Proof Stem
- Vacuum Service to 29" Hg
- Locking Handle (SCL208 only)
- MSS SP-110
- ISO 9001:2008 Manufacturer
- Lead Free



Size in	Part Number		Packing		Weight lb
	Threaded	w/ Locking Handle	Inner	Master	
1/4	SC208C	SCL208C	12	48	0.36
3/8	SC208E	SCL208E	12	48	0.35
1/2	SC208G	SCL208G	8	32	0.52
3/4	SC208I	SCL208I	12	24	0.95
1	SC208K	SCL208K	8	16	1.21
1-1/4	SC208L	SCL208L	6	12	1.95
1-1/2	SC208M	SCL208M	4	8	2.74
2	SC208N	SCL208N	2	4	4.44

Series SC301 316 Stainless Steel Three-Piece Ball Valve

- 1000# CWP, 150# WSP
- Full Port
- Body: ASTM A351 GR CF8M (SS316)
- End Caps: ASTM A351 GR CF8M (SS316)
- Ball: ASTM A351 GR CF8M (SS316)
- Stem: ASTM A 276 T-316
- RTFE Seats
- Blow-Out Proof Stem
- MSS SP-110
- Vacuum Service to 29" Hg
- Locking Handle
- ISO 9001:2008 Manufacturer
- Repair Kits, Lever Handles and Oval Handles Available
- Threaded and Socketweld Available
- Lead Free



Size in	Part Number		Packing		Weight lb
	Threaded	Socket Weld	Inner	Master	
1/4	SC301THC	-	6	24	0.67
3/8	SC301THE	-	6	24	0.68
1/2	SC301THG	SC301SWG	8	16	1.01
3/4	SC301THI	SC301SWI	8	16	1.33
1	SC301THK	SC301SWK	6	12	1.96
1-1/4	SC301THL	SC301SWL	4	8	2.96
1-1/2	SC301THM	SC301SWM	-	4	4.55
2	SC301THN	SC301SWN	-	3	7.13
2-1/2	SC301THP	-	-	2	15.87
3	SC301THQ	-	-	2	23.53
4	SC301THT	-	-	2	46.19

LEAD FREE

Series SC402
316 Stainless Steel Gate Valve

- 200# CWP, 125# WSP
- 316 Stainless Steel
- Solid Wedge Disc
- Screwed in Bonnet
- Non-Rising Stem
- ISO 9001:2008 Manufacturer
- Lead Free



Size in	Part Number Threaded	Packing Master	Weight lb
1/2	SC402G	30	0.9
3/4	SC402I	25	1.2
1	SC402K	20	1.5
1-1/4	SC402L	15	2.2
1-1/2	SC402M	10	3.4
2	SC402N	5	4.5

Series SC602
316 Stainless Steel Check Valve

- 200# CWP, 125# WSP
- 316 Stainless Steel
- Metal-to-Metal Seat
- Screwed Cap
- ISO 9001:2008 Manufacturer
- Lead Free



Size in	Part Number Threaded	Packing Master	Weight lb
1/2	SC602G	25	0.7
3/4	SC602I	16	1.0
1	SC602K	12	1.5
1-1/4	SC602L	9	2.2
1-1/2	SC602M	10	3.3
2	SC602N	8	4.7
2-1/2	SC602P	2	10.0
3	SC602Q	2	16.7

316 Stainless Steel Globe Valve

- 200# CWP, 125# WSP
- 316 Stainless Steel
- Metal-to-Metal Seat
- Screwed in Bonnet
- Rising Stem
- ISO 9001:2008 Manufacturer
- Lead Free



Size in	Part Number Threaded	Packing Master	Weight lb
1/2	SC502G	40	0.7
3/4	SC502I	25	1.0
1	SC502K	20	1.4
1-1/4	SC502L	15	1.5
1-1/2	SC502M	10	2.8
2	SC502N	6	4.7

Series SCYS8
316 Stainless Steel Threaded Wye Strainer

- 800# CWP, 150# WSP
- 20 Mesh 316 Stainless Steel Screen
- Start-up screen included
- Blow-Down Plug
- Lead Free



Size in	Part Number Threaded	Weight lb
1/2	SCYS8004	0.5
3/4	SCYS8006	0.8
1	SCYS8010	1.6
1-1/4	SCYS8012	2.0
1-1/2	SCYS8014	2.7
2	SCYS8020	4.3

Each valve is individually tagged with CWP and WSP pressure ratings, alloy of body, ball and stem, series number and notice of LEAD FREE.



Series 0384
PTFE Tape with Nickel

- Use on Stainless Steel Threads
- 90% PTFE / 10% Nickel
- Melting Point 620°F (327°C)
- Thickness .0045 (±.0005)
- ISO 9001:2008 Manufacturer
- ASTM Mill Spec T-27730A



Size in	Part Number	Length in	Packing Inner	Packing Master	Weight lb
1/2	0384260G	260	100	600	0.02
3/4	0384260I	260	50	300	0.04

LEAD FREE

Series 103L Brass Boiler Drain with Stuffing Box

- Certified to SWDA and California AB1953
- Certified to NSF/ANSI 61-8
- 125 lb. CWP
- Full flow
- Cast brass
- CSA Approved
- ISO 9001:2008 manufacturer



Size in	Part Number	Packing		Weight lb
	Male	Inner	Master	
1/2	0190103GL	12	72	0.5
3/4	0190103IL	12	72	0.5

Series 112L Brass Flanged Sillcock with Stuffing Box

- Certified to SWDA and California AB1953
- Certified to NSF/ANSI 61-8
- 125 lb. CWP
- Cast brass
- ISO 9001:2008 Manufacturer



Size in	Part Number	Packing		Weight lb
	Female	Inner	Master	
1/2	0190112GL	10	60	0.6
3/4	0190112IL	8	48	0.6

Series 167L Vacuum Breaker

- Certified to SWDA and California AB1953
- Certified to NSF/ANSI 61-8
- ASSE/UPC Approved and marked
- Flat sealing washer
- Break away locking screw



Size in	Part Number	Packing		Weight lb
	Female/Male	Inner	Master	
3/4	0190167IIL	20	200	0.2

Series 160L Brass Hose Bibb, MIP Inlet

- Certified to SWDA and California AB1953
- Certified to NSF/ANSI 61-8
- 125 lb. CWP
- Cast brass



Size in	Part Number	Packing		Weight lb
	Male	Inner	Master	
1/2	0190160GL	15	90	0.4
3/4	0190160IL	15	90	0.4

Series 166L Brass No Kink Hose Bibb, MIP Inlet

- Certified to SWDA and California AB1953
- 125 lb. CWP
- Cast brass
- Heavy duty construction
- Green Tee handle
- Certified to NSF/ANSI 61-8
- ISO 9001:2008 manufacturer



Size in	Part Number	Packing		Weight lb
	Male	Inner	Master	
1/2	0190166GL	10	60	0.6
3/4	0190166IL	10	60	0.6

Series 167L Brass No Kink Hose Bibb, Compression Inlet

- Certified to SWDA and California AB1953
- Certified to NSF/ANSI 61-8
- 125 lb. CWP
- Cast brass
- Heavy duty construction
- Green tee handle
- ISO 9001:2008 manufacturer



Size in	Part Number	Packing		Weight lb
	Compression	Inner	Master	
1/2	0190167GL	15	90	0.5

Series 168L Brass No Kink Hose Bibb, FIP Inlet

- Certified to SWDA and California AB1953
- Certified to NSF/ANSI 61-8
- 125 lb. CWP
- Cast brass
- Heavy duty construction
- Green tee handle
- ISO 9001:2008 manufacturer



Size in	Part Number	Packing		Weight lb
	Female	Inner	Master	
1/2	0190168GL	15	90	0.4
3/4	0190168IL	15	90	0.5

Series 169L
Brass No Kink Hose Bibb,
MIP Inlet

- Certified to SWDA and California AB1953
- Certified to NSF/ANSI 61-8
- 125 lb. CWP
- Cast brass
- Heavy duty construction
- Green tee handle
- ISO 9001:2008 manufacturer



Size in	Part Number		Packing		Weight lb
	Male		Inner	Master	
1/2	0190169GL		15	90	0.5
3/4	0190169IL		15	90	0.5

Series 169IGL
Brass No Kink Hose Bibb,
Sweat Inlet

- Certified to SWDA and California AB1953
- Certified to NSF/ANSI 61-8
- 125 lb. CWP
- Cast brass
- Heavy duty construction
- Green tee handle
- ISO 9001:2008 manufacturer



Size in	Part Number		Packing		Weight lb
	Male / Fem SWT		Inner	Master	
3/4 x 1/2	0190169IGL		15	90	0.5

Series 120L & 125L
Washing Machine Valves

- Certified to SWDA and California AB1953
- Certified to NSF/ANSI 61-8
- 125 lb. CWP
- Cast brass
- Satin nickel finish



Size in	Part Number	Ends Config.	Packing		Weight lb
			Inner	Master	
1/2	0190120GL	FIP x MHT	12	120	0.3
5/8 OD	0190125GL	Comp x MHT	12	120	0.4

Series 161 & 162
Transition Adapter

- Brass to CPVC
- Certified to NSF/ANSI 61.9



Size in	Part Number		Packing		Weight lb
	MIP x Slip	FIP x Slip	Inner	Master	
1/2	0945161G	0945162G	50	300	0.2
3/4	0945161I	0945162I	50	300	0.2

Series 209MXL
Male Iron Pipe x Brass Sweat
Dielectric Union

- Certified to SWDA and California AB1953
- Certified to NSF/ANSI 372
- Forged steel construction
- Zinc plated
- Self-centering washer
- Temperatures up to 212°F (100°C)

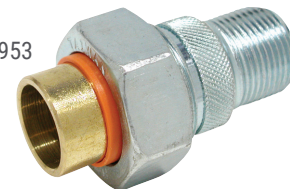

Size in	Part Number	Ends Config.	Packing		Weight lb
			Inner	Master	
1/2	0209MXGL	MIP x SWT	12	144	0.5
3/4	0209MXIL	MIP x SWT	12	144	0.6
1	0209MXKL	MIP x SWT	12	144	1.0

Series 209FXL
Female IPS x Brass Sweat
Dielectric Union

- Certified to SWDA and California AB1953
- Certified to NSF/ANSI 372
- Forged steel construction
- Zinc plated
- Self-centering washer
- Temperatures up to 212°F (100°C)

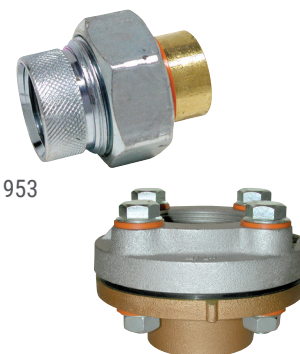

Size in	Part Number	Ends Config.	Packing		Weight lb
			Inner	Master	
1/2	0209FXGL	FIP x SWT	12	144	0.3
3/4	0209FXIL	FIP x SWT	12	144	0.4
3/4 x 1/2	0209FXIGL	FIP x SWT	12	144	0.4
1	0209FXKL	FIP x SWT	12	120	0.6
1-1/4	0209FXLL	FIP x SWT	6	48	0.9
1-1/2	0209FXML	FIP x SWT	6	48	1.4
2	0209FXNL	FIP x SWT	6	24	2.7
2-1/2	0209FXPL	FIP x SWT	-	5	13.2
3	0209FXQL	FIP x SWT	-	5	15.6
4	0209FXTL	FIP x SWT	-	2	29.7

Series 209FFL
Female IPS x Female IPS
Dielectric Union

- Certified to SWDA and California AB1953
- Certified to NSF/ANSI 372
- Forged steel construction
- Zinc plated
- Self-centering washer
- Temperatures up to 212°F (100°C)

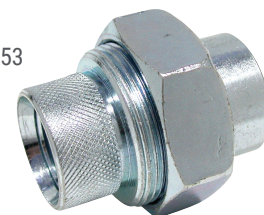

Size in	Part Number	Ends Config.	Packing		Weight lb
			Inner	Master	
1/2	0209FFGL	FIP x FIP	10	100	0.5
3/4	0209FFIL	FIP x FIP	10	100	0.7
1	0209FFKL	FIP x FIP	5	50	1.1

QUICKBITE™ BY SMITH-COOPER® INTERNATIONAL

No special tools required. No gluing, crimping or soldering required.

QUICKBITE™ valves and fittings are the simplest connectors to use.

- 1 - Clean the tube
- 2 - Press on the QUICKBITE™ fitting or valve
- 3 - DONE! No leak seal

QUICKBITE™ Quick Facts:

- Fittings certified to 200 PSI and 180° F
- Works with PEX, CPVC and copper tubing
- PEX stiffener pre-installed - Easy to remove for PVC or Copper installations
- Lead-free brass
- Full flow
- Fittings & valves are removable and reusable
- Easy-to-follow instructions are available at www.smithcooper.com/QR1 or by scanning the QR code on the back of every bag

LEAD FREE

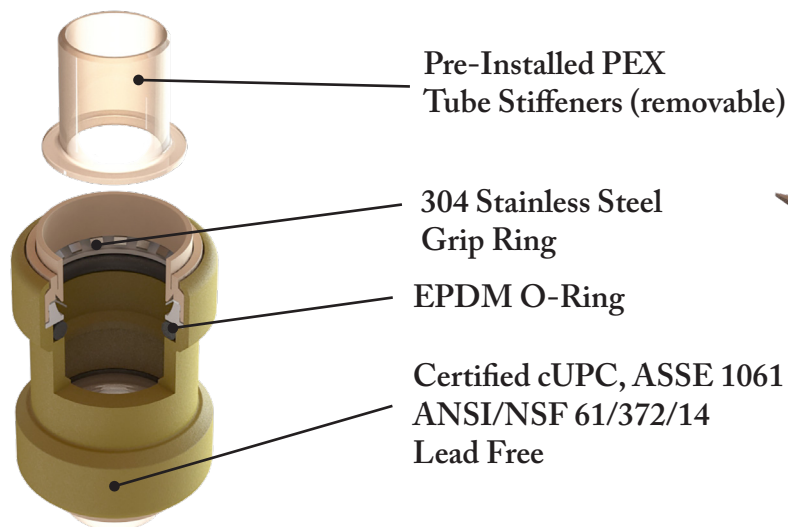

Fig. QBBV - Valve

Size in	Part Number	Packing		Weight lb
		Inner	Master	
1/2	QBBV004	10	20	0.408
3/4	QBBV006	10	20	0.598
1	QBBV010	5	10	1.152

Fig. QBE - Elbow

Size in	Part Number	Packing		Weight lb
		Inner	Master	
3/8	QBE003	10	40	0.131
1/2	QBE004	10	40	0.149
3/4	QBE006	10	20	0.272
1	QBE010	5	20	0.471
* 1-1/4	QBE012	-	Bulk	-
* 1-1/2	QBE014	-	Bulk	-
* 2	QBE020	-	Bulk	-



Size in	Part Number	Packing		Weight lb
		Inner	Master	
3/4 x 1/2	QBRE006004	10	40	0.210
1 x 3/4	QBRE010006	10	20	0.371

Fig. QBFE - Female Adapter Elbow (Push x FNPT)

Size in	Part Number	Packing		Weight lb
		Inner	Master	
1/2 x 1/2	QBFE004	10	40	0.178
3/4 x 3/4	QBFE006	10	20	0.290
1 x 1	QBFE010	5	20	0.425

**Fig. QBME - Male Adapter Elbow (Push x MNPT)**

Size in	Part Number	Packing		Weight lb
		Inner	Master	
1/2 x 1/2	QBME004	10	40	0.180
3/4 x 3/4	QBME006	10	20	0.290
1 x 1	QBME010	5	20	0.477

**Fig. QBDE - Drop Ear Elbow (Push x FNPT)**

Size in	Part Number	Packing		Weight lb
		Inner	Master	
1/2 x 1/2	QBDE004	10	40	0.218
3/4 x 3/4	QBDE006	10	20	0.359



* Available upon request

LEAD FREE



Fig. QBT - Tee

Size in	Part Number	Packing		Weight lb
		Inner	Master	
3/8	QBT003	10	40	0.163
1/2	QBT004	10	40	0.199
3/4	QBT006	10	20	0.355
1	QBT010	5	10	0.621
* 1-1/4	QBT012	-	Bulk	-
* 1-1/2	QBT014	-	Bulk	-
* 2	QBT020	-	Bulk	-



Fig. QBRT - Reducing Tee

Size in	Part Number	Packing		Weight lb
		Inner	Master	
* 1/2 x 1/2 x 3/4	QBRT004004006	-	Bulk	-
* 1/2 x 1/2 x 1	QBRT004004010	-	Bulk	-
3/4 x 1/2 x 1/2	QBRT006004004	10	20	0.257
3/4 x 1/2 x 3/4	QBRT006004006	10	20	0.332
3/4 x 3/4 x 1/2	QBRT006004	10	20	0.322
3/4 x 3/4 x 1	QBRT006006010	5	20	-
1 x 1 x 3/4	QBRT010006	5	10	0.520



Fig. QBCP - Coupling

Size in	Part Number	Packing		Weight lb
		Inner	Master	
3/8	QBCP003	10	40	0.104
1/2	QBCP004	10	40	0.122
3/4	QBCP006	10	40	0.192
1	QBCP010	5	20	0.310
* 1-1/4	QBCP012	-	Bulk	-
* 1-1/2	QBCP014	-	Bulk	-
* 2	QBCP020	-	Bulk	-



Fig. QBRC - Reducing Coupling

Size in	Part Number	Packing		Weight lb
		Inner	Master	
3/8 X 1/2	QBRC003004	10	40	0.136
3/4 x 1/2	QBRC006004	10	40	0.167
1 x 3/4	QBRC010006	10	20	0.259



Fig. QBSC - Slip Coupling

Size in	Part Number	Packing		Weight lb
		Inner	Master	
1/2	QBSC004	10	40	0.230
3/4	QBSC006	10	20	0.364
1	QBSC010	5	20	0.521

* Available upon request

LEAD FREE

Fig. QBMA - Male Adapter (Push x MNPT)

Size in	Part Number	Packing		Weight lb
		Inner	Master	
3/8 X 3/8	QBMA003	10	40	0.087
1/2 x 1/2	QBMA004	10	40	0.114
1/2 x 3/4	QBMA004006	10	40	0.163
* 3/4 x 1/2	QBMA006004	-	Bulk	-
3/4 x 3/4	QBMA006	10	40	0.182
3/4 x 1	QBMA006010	5	20	0.245
1 x 3/4	QBMA010006	5	20	0.245
1 x 1	QBMA010	5	20	0.256
* 1-1/4 x 1-1/4	QBMA012	-	Bulk	-
* 1-1/2 x 1-1/2	QBMA014	-	Bulk	-
* 2 x 2	QBMA020	-	Bulk	-



Fig. QBFA - Female Adapter (Push x FNPT)

Size in	Part Number	Packing		Weight lb
		Inner	Master	
1/2 x 1/2	QBFA004	10	40	0.115
1/2 x 3/4	QBFA004006	10	40	0.166
* 3/4 x 1/2	QBFA006004	-	Bulk	-
3/4 x 3/4	QBFA006	10	40	0.198
3/4 x 1	QBFA006010	5	20	0.238
* 1 x 3/4	QBFA010006	-	Bulk	-
1 x 1	QBFA010	5	20	0.276
* 1-1/4 x 1-1/4	QBFA012	-	Bulk	-
* 1-1/2 x 1-1/2	QBFA014	-	Bulk	-
* 2 x 2	QBFA020	-	Bulk	-



Fig. QBC - Cap

Size in	Part Number	Packing		Weight lb
		Inner	Master	
3/8	QBC003	10	40	0.041
1/2	QBC004	10	40	0.069
3/4	QBC006	10	40	0.122
1	QBC010	5	20	0.199
* 1-1/4	QBC012	-	Bulk	-
* 1-1/2	QBC014	-	Bulk	-
* 2	QBC020	-	Bulk	-



Fig. QBDT - Disconnect Tool

Size in	Part Number	Packing		Weight lb
		Inner	Master	
** 3/8	QBDT003	10	40	0.040
** 1/2	QBDT004	10	40	0.070
** 3/4	QBDT006	10	20	0.170
** 1	QBDT010	5	10	0.240



Fig. QBS - Stiffener

Size in	Part Number	Packing		Weight lb
		Inner	Master	
** 1/2	QBS004	10	40	0.050
** 3/4	QBS006	10	20	0.080
** 1	QBS010	5	20	0.050



* Available upon request ** One unit = a pack of 10

LEAD FREE

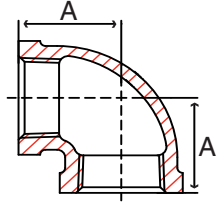

Fig. 36E 1L – 90° Elbow

Size in	Part Number	A in	Packing		Weight lb
			Inner	Master	
1/8	36E 1001L	0.54	50	800	0.1
1/4	36E 1002L	0.71	35	560	0.1
3/8	36E 1003L	0.82	45	360	0.1
1/2	36E 1004L	1.01	50	200	0.2
3/4	36E 1006L	1.18	35	140	0.3
1	36E 1010L	1.43	20	80	0.6
1-1/4	36E 1012L	1.69	20	40	0.9
1-1/2	36E 1014L	1.84	15	30	1.2
2	36E 1020L	2.12	8	16	2.0
2-1/2	36E 1024L	2.70	6	12	3.8
3	36E 1030L	3.08	-	7	4.7
4	36E 1040L	3.79	-	3	9.7

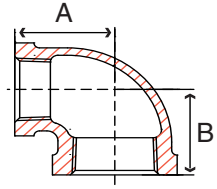

Fig. 36RE1L – 90° Reducing Elbow

Size in	Part Number	A in	B in	Packing		Weight lb
				Inner	Master	
1/2 x 1/4	36RE1004002L	0.98	0.97	50	400	0.2
1/2 x 3/8	36RE1004003L	0.93	0.90	50	200	0.2
3/4 x 1/2	36RE1006004L	1.11	1.08	50	200	0.4
1 x 1/2	36RE1010004L	1.24	1.20	25	100	0.5
1 x 3/4	36RE1010006L	1.31	1.30	30	120	0.5
1-1/4 x 3/4	36RE1012006L	1.48	1.39	15	60	0.7
1-1/4 x 1	36RE1012010L	1.60	1.52	10	40	0.7
1-1/2 x 1	36RE1014010L	1.72	1.55	10	40	1.0
1-1/2 x 1-1/4	36RE1014012L	1.81	1.72	8	32	1.0
2 x 1	36RE1020010L	2.02	1.73	14	28	1.4
2 x 1-1/4	36RE1020012L	2.10	1.90	10	20	1.5
2 x 1-1/2	36RE1020014L	2.07	1.89	10	20	1.6
2-1/2 x 2	36RE1024020L	2.60	2.39	8	16	3.1
3 x 2-1/2	36RE1030024L	2.99	2.83	-	8	4.0

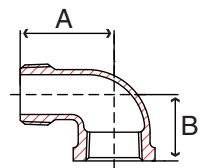

Fig. 36SE1L – 90° Street Elbow

Size in	Part Number	A in	B in	Packing		Weight lb
				Inner	Master	
1/8	36SE1001L	0.92	0.54	60	960	0.1
1/4	36SE1002L	1.11	0.71	35	560	0.1
3/8	36SE1003L	1.24	0.82	40	320	0.1
1/2	36SE1004L	1.48	1.01	75	300	0.2
3/4	36SE1006L	1.65	1.18	40	160	0.3
1	36SE1010L	1.98	1.43	40	80	0.5
1-1/4	36SE1012L	2.24	1.69	25	50	0.8
1-1/2	36SE1014L	2.46	1.84	9	36	1.1
2	36SE1020L	2.88	2.12	10	20	2.0
2-1/2	36SE1024L	3.86	2.70	-	10	4.0
3	36SE1030L	4.51	3.08	-	7	4.7
4	36SE1040L	5.69	3.79	-	3	11.4

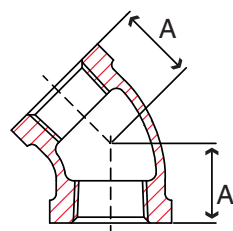

Fig. 36F 1L – 45° Elbow

Size in	Part Number	A in	Packing		Weight lb
			Inner	Master	
1/8	36F 1001L	0.42	50	800	0.1
1/4	36F 1002L	0.56	30	480	0.1
3/8	36F 1003L	0.63	50	400	0.1
1/2	36F 1004L	0.78	50	200	0.2
3/4	36F 1006L	0.89	40	160	0.3
1	36F 1010L	1.06	20	80	0.5
1-1/4	36F 1012L	1.22	20	40	0.7
1-1/2	36F 1014L	1.30	8	32	1.0
2	36F 1020L	1.45	12	24	1.7
2-1/2	36F 1024L	1.95	-	15	3.2
3	36F 1030L	2.17	-	10	4.7
4	36F 1040L	2.61	-	3	8.1

Fig. 36SF1L – 45° Street Elbow

Size in	Part Number	A in	B in	Packing		Weight lb
				Inner	Master	
1/8	36SF1001L	0.42	0.78	70	1120	0.05
1/4	36SF1002L	0.56	0.88	40	640	0.1
3/8	36SF1003L	0.63	0.92	50	600	0.1
1/2	36SF1004L	0.78	1.06	75	300	0.2
3/4	36SF1006L	0.89	1.23	40	160	0.3
1	36SF1010L	1.06	1.40	25	100	0.5
1-1/4	36SF1012L	1.22	1.64	10	40	0.7
1-1/2	36SF1014L	1.30	1.80	10	40	1.0
2	36SF1020L	1.45	2.14	12	24	1.5
2-1/2	36SF1024L	1.95	2.57	5	10	3.0

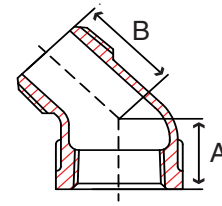

Fig. 36T 1L – Tee

Size in	Part Number	A in	Packing		Weight lb
			Inner	Master	
1/8	36T 1001L	0.54	80	640	0.1
1/4	36T 1002L	0.71	50	400	0.1
3/8	36T 1003L	0.82	30	240	0.2
1/2	36T 1004L	1.01	40	160	0.3
3/4	36T 1006L	1.18	25	100	0.5
1	36T 1010L	1.43	25	50	0.8
1-1/4	36T 1012L	1.69	14	28	1.2
1-1/2	36T 1014L	1.84	15	30	1.6
2	36T 1020L	2.12	-	15	2.7
2-1/2	36T 1024L	2.70	-	10	5.1
3	36T 1030L	3.08	-	6	7.5
4	36T 1040L	3.79	-	2	13.3

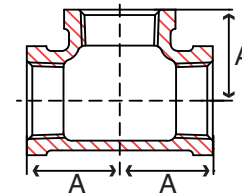

Fig. 36BT1L – Bull Head Tee

Size in	Part Number	A in	B in	C in	Packing		Weight lb
					Inner	Master	
1/2 x 3/4	36BT1004006L	1.11	1.11	1.08	25	100	0.4
3/4 x 1	36BT1006010L	1.31	1.31	1.30	15	60	0.7

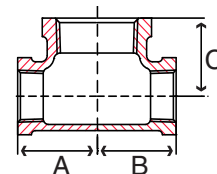
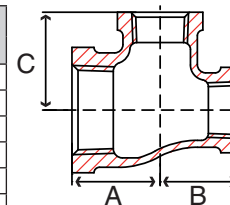

Fig. 36RT1L – Reducing Tee

Size in	Part Number	A in	B in	C in	Packing		Weight lb
					Inner	Master	
1/2 x 1/4	36RT1004002L	0.87	0.87	0.87	25	200	0.2
1/2 x 3/8	36RT1004003L	0.93	0.93	0.90	25	200	0.3
3/4 x 1/4	36RT1006002L	1.00	1.00	1.00	25	100	0.4
3/4 x 3/8	36RT1006003L	1.00	1.00	1.00	25	100	0.4
3/4 x 1/2	36RT1006004L	1.08	1.08	1.11	25	100	0.5
1 x 1/2	36RT1010004L	1.20	1.20	1.24	15	60	0.6
1 x 3/4	36RT1010006L	1.30	1.18	1.31	15	60	0.8
1 x 3/4 x 1	36RT1010006010L	1.43	1.31	1.43	15	60	0.8
1-1/4 x 1/2	36RT1012004L	1.29	1.29	1.41	20	40	0.8
1-1/4 x 3/4	36RT1012006L	1.39	1.39	1.48	20	40	0.9
1-1/4 x 1	36RT1012010L	1.52	1.52	1.60	20	40	1.2
1-1/2 x 3/4	36RT1014006L	1.42	1.42	1.60	15	30	1.3
1-1/2 x 1	36RT1014010L	1.55	1.55	1.72	15	30	1.2
1-1/2 x 1-1/4	36RT1014012L	1.72	1.72	1.81	12	24	1.7
2 x 1/2	36RT1020004L	1.47	1.47	1.84	12	24	1.8
2 x 3/4	36RT1020006L	1.47	1.47	1.84	12	24	1.9
2 x 1	36RT1020010L	1.59	1.59	1.95	10	20	2.0
2 x 1-1/4	36RT1020012L	1.77	1.77	2.04	8	16	2.2
2 x 1-1/2	36RT1020014L	1.89	1.89	2.07	8	16	2.6
2-1/2 x 1-1/4	36RT1024012L	2.04	2.04	2.45	-	10	3.2
2-1/2 x 1-1/2	36RT1024014L	2.16	2.16	2.51	-	10	3.8
2-1/2 x 2	36RT1024020L	2.39	2.39	2.60	-	10	4.2
3 x 1-1/2	36RT1030014L	2.29	2.29	2.80	-	6	4.9
3 x 2	36RT1030020L	2.52	2.52	2.89	-	6	3.7



Lead Free Bronze Fittings

LEAD FREE

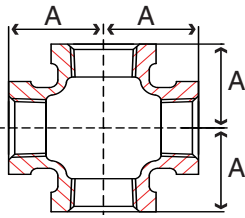
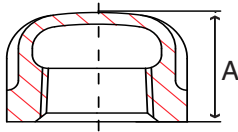

Fig. 36X 1L – Cross

Size in	Part Number	A in	Packing		Weight lb
			Inner	Master	
1/8	36X 1001L	0.54	20	320	0.1
1/4	36X 1002L	0.71	40	320	0.2
3/8	36X 1003L	0.82	40	160	0.1
1/2	36X 1004L	1.01	30	120	0.4
3/4	36X 1006L	1.18	20	80	0.7
1	36X 1010L	1.43	20	40	1.0
1-1/4	36X 1012L	1.69	-	20	1.6
1-1/2	36X 1014L	1.84	-	18	2.1
2	36X 1020L	2.12	-	10	3.2
2-1/2	36X 1024L	2.70	-	6	5.5
3	36X 1030L	3.08	-	4	8.2

Fig. 36C 1L – Cap



Size in	Part Number	A in	Packing		Weight lb
			Inner	Master	
1/8	36C 1001L	0.53	120	1920	0.03
1/4	36C 1002L	0.63	80	1280	0.06
3/8	36C 1003L	0.68	60	720	0.1
1/2	36C 1004L	0.80	75	600	0.1
3/4	36C 1006L	0.90	40	320	0.1
1	36C 1010L	1.08	25	200	0.3
1-1/4	36C 1012L	1.12	25	100	0.5
1-1/2	36C 1014L	1.17	25	100	0.6
2	36C 1020L	1.36	18	72	0.9
2-1/2	36C 1024L	1.70	20	40	1.9
3	36C 1030L	1.80	12	24	2.7
4	36C 1040L	2.08	6	12	4.4

Fig. 36SC1L – Square Head Cored Plug

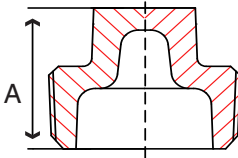

Size in	Part Number	A in	Packing		Weight lb
			Inner	Master	
1/2	36SC1004L	1.00	50	800	0.1
3/4	36SC1006L	1.15	30	360	0.1
1	36SC1010L	1.30	20	240	0.2
1-1/4	36SC1012L	1.40	40	160	0.3
1-1/2	36SC1014L	1.50	30	120	0.5
2	36SC1020L	1.60	20	80	0.7
2-1/2	36SC1024L	1.85	16	64	1.0
3	36SC1030L	1.95	16	32	2.0
4	36SC1040L	2.30	8	16	3.6

Fig. 36SS1L – Square Head Solid Plug

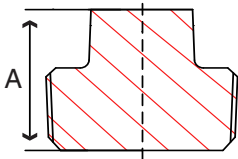

Size in	Part Number	A in	Packing		Weight lb
			Inner	Master	
1/8	36SS1001L	0.65	300	4800	0.02
1/4	36SS1002L	0.75	150	2400	0.03
3/8	36SS1003L	0.85	100	1600	0.06
1/2	36SS1004L	1.00	50	800	0.1
3/4	36SS1006L	1.15	30	360	0.1
1	36SS1010L	1.30	20	240	0.3
1-1/4	36SS1012L	1.40	40	160	0.6
1-1/2	36SS1014L	1.50	30	120	0.8
2	36SS1020L	1.60	20	80	1.2

Fig. 36U 1L – Union

Size in	Part Number	A in	Packing		Weight lb
			Inner	Master	
1/8	36U 1001L	1.34	30	480	0.1
1/4	36U 1002L	1.45	20	240	0.2
3/8	36U 1003L	1.60	20	160	0.3
1/2	36U 1004L	1.60	40	160	0.5
3/4	36U 1006L	1.80	40	80	0.7
1	36U 1010L	2.00	30	60	1.1
1-1/4	36U 1012L	2.07	20	40	1.6
1-1/2	36U 1014L	2.33	15	30	2.0
2	36U 1020L	2.53	10	20	3.2
2-1/2	36U 1024L	3.33	-	10	5.3
3	36U 1030L	3.60	-	7	6.9
4	36U 1040L	3.80	-	4	12.0

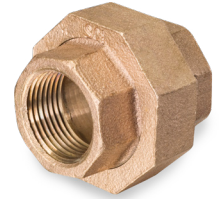
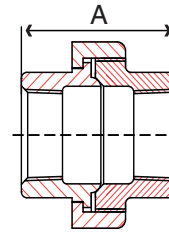
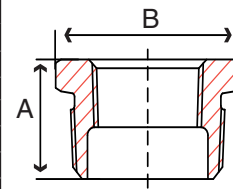

Fig. 36HB1L – Hex Bushing

Size in	Part Number	A in	B in	Hex	Packing		Weight lb
					Inner	Master	
1/4 x 1/8	36HB1002001L	0.61	0.66	Out	120	1920	0.05
3/8 x 1/8	36HB1003001L	0.81	0.73	Out	75	1200	0.05
3/8 x 1/4	36HB1003002L	0.81	0.73	Out	75	1200	0.05
1/2 x 1/8	36HB1004001L	0.95	0.88	Out	100	800	0.1
1/2 x 1/4	36HB1004002L	0.81	0.90	Out	100	800	0.09
1/2 x 3/8	36HB1004003L	0.81	0.90	Out	100	800	0.07
3/4 x 1/8	36HB1006001L	0.88	1.18	Out	50	600	0.1
3/4 x 1/4	36HB1006002L	0.93	1.18	Out	40	480	0.1
3/4 x 3/8	36HB1006003L	0.93	1.18	Out	50	600	0.1
3/4 x 1/2	36HB1006004L	0.93	1.18	Out	40	480	0.1
1 x 1/4	36HB1010002L	1.13	1.12	In	50	400	0.2
1 x 3/8	36HB1010003L	1.13	1.12	In	50	400	0.2
1 x 1/2	36HB1010004L	1.10	1.44	Out	40	320	0.2
1 x 3/4	36HB1010006L	1.10	1.44	Out	40	360	0.2
1-1/4 x 1/2	36HB1012004L	1.18	1.80	Out	30	120	0.3
1-1/4 x 3/4	36HB1012006L	1.18	1.80	Out	30	120	0.4
1-1/4 x 1	36HB1012010L	1.18	1.80	Out	30	120	0.3
1-1/2 x 1/2	36HB1014004L	1.27	1.34	In	25	100	0.4
1-1/2 x 3/4	36HB1014006L	1.27	1.63	In	25	100	0.4
1-1/2 x 1	36HB1014010L	1.19	2.04	Out	25	100	0.5
1-1/2 x 1-1/4	36HB1014012L	1.19	2.04	Out	25	100	0.4
2 x 1/2	36HB1020004L	1.35	1.36	In	20	80	0.6
2 x 3/4	36HB1020006L	1.35	1.65	In	20	80	0.7
2 x 1	36HB1020010L	1.35	2.00	In	20	80	0.7
2 x 1-1/4	36HB1020012L	1.35	2.50	Out	20	80	0.8
2 x 1-1/2	36HB1020014L	1.35	2.55	Out	20	80	0.8
2-1/2 x 1-1/4	36HB1024012L	1.60	3.15	Out	12	48	1.2
2-1/2 x 1-1/2	36HB1024014L	1.52	2.70	In	12	48	1.3
2-1/2 x 2	36HB1024020L	1.62	3.15	Out	12	48	1.1
3 x 1	36HB1030010L	1.60	2.00	In	12	48	1.6
3 x 1-1/2	36HB1030014L	1.70	2.70	In	12	48	1.8
3 x 2	36HB1030020L	1.70	3.25	In	6	24	2.3
3 x 2-1/2	36HB1030024L	1.70	3.90	Out	6	24	2.1
4 x 2	36HB1040020L	1.80	3.30	In	-	20	3.6
4 x 2-1/2	36HB1040024L	2.10	4.75	Out	-	20	3.9
4 x 3	36HB1040030L	2.10	4.75	Out	-	20	4.2



LEAD FREE

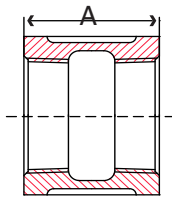

Fig. 36CP1L – Coupling

Size in	Part Number	A in	Packing		Weight lb
			Inner	Master	
1/8	36CP1001L	0.80	70	1120	0.1
1/4	36CP1002L	0.97	40	640	0.1
3/8	36CP1003L	1.05	50	600	0.1
1/2	36CP1004L	1.29	40	320	0.1
3/4	36CP1006L	1.43	50	200	0.2
1	36CP1010L	1.68	25	100	0.4
1-1/4	36CP1012L	1.86	20	80	0.6
1-1/2	36CP1014L	1.92	12	48	0.8
2	36CP1020L	2.20	12	24	1.3
2-1/2	36CP1024L	2.88	8	16	2.6
3	36CP1030L	3.18	8	16	3.7
4	36CP1040L	3.69	-	6	5.8

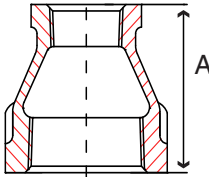

Fig. 36RC1L – Reducing Coupling

Size in	Part Number	A in	Packing		Weight lb
			Inner	Master	
1/4 x 1/8	36RC1002001L	0.88	50	600	0.08
3/8 x 1/8	36RC1003001L	0.92	35	420	0.1
3/8 x 1/4	36RC1003002L	1.01	40	480	0.1
1/2 x 1/8	36RC1004001L	1.13	50	400	0.1
1/2 x 1/4	36RC1004002L	1.13	50	400	0.1
1/2 x 3/8	36RC1004003L	1.17	40	320	0.1
3/4 x 1/8	36RC1006001L	1.24	35	280	0.1
3/4 x 1/4	36RC1006002L	1.24	30	240	0.2
3/4 x 3/8	36RC1006003L	1.24	50	200	0.2
3/4 x 1/2	36RC1006004L	1.36	60	240	0.2
1 x 1/4	36RC1010002L	1.49	45	180	0.3
1 x 3/8	36RC1010003L	1.49	30	120	0.4
1 x 1/2	36RC1010004L	1.49	30	120	0.3
1 x 3/4	36RC1010006L	1.56	25	100	0.4
1-1/4 x 1/2	36RC1012004L	1.65	25	100	0.6
1-1/4 x 3/4	36RC1012006L	1.65	25	100	0.6
1-1/4 x 1	36RC1012010L	1.77	15	60	0.5
1-1/2 x 1/2	36RC1014004L	1.8	15	60	0.7
1-1/2 x 3/4	36RC1014006L	1.8	15	60	0.8
1-1/2 x 1	36RC1014010L	1.8	15	60	0.6
1-1/2 x 1-1/4	36RC1014012L	1.89	12	48	0.9
2 x 1/2	36RC1020004L	2.03	12	48	1.2
2 x 3/4	36RC1020006L	2.03	12	48	1.2
2 x 1	36RC1020010L	2.03	12	48	0.9
2 x 1-1/4	36RC1020012L	2.03	14	28	1.3
2 x 1-1/2	36RC1020014L	2.06	12	24	1.0
2-1/2 x 1-1/2	36RC1024014L	3.25	-	25	2.2
2-1/2 x 2	36RC1024020L	3.25	-	25	2.4
3 x 1	36RC1030010L	3.69	-	20	2.5
3 x 1-1/4	36RC1030012L	3.69	-	20	2.1
3 x 1-1/2	36RC1030014L	3.69	-	20	2.3
3 x 2	36RC1030020L	3.69	-	20	3.6
3 x 2-1/2	36RC1030024L	3.69	-	12	3.9
4 x 2	36RC1040020L	4.38	-	10	6.0
4 x 2-1/2	36RC1040024L	4.38	-	10	5.9
4 x 3	36RC1040030L	4.38	-	6	6.5



LEAD
FREE



LEAD FREE OPTION!

About ASC Engineered Solutions

ASC Engineered Solutions is defined by quality—in its products, services and support. With more than 1,400 employees, the company’s portfolio of precision-engineered piping support, valves and connections provides products to more than 4,000 customers across industries, such as mechanical, industrial, fire protection, oil and gas, and commercial and residential construction. Its portfolio of leading brands includes ABZ Valve®, AFCON®, Anvil®, Anvil EPS, Anvil Services, Basic-PSA, Beck®, Catawissa, Cooplet®, FlexHead®, FPPI®, Gruvlok®, J.B. Smith, Merit®, North Alabama Pipe, Quadrant®, SCI®, Sharpe®, SlideLOK®, SPF® and SprinkFLEX®. With headquarters in Commerce, CA, and Exeter, NH, ASC also has ISO 9001:2015 certified production facilities in PA, TN, IL, TX, AL, LA, KS, and RI.



asc-es.com

Building connections that last™

